

Phase 1 - Data Collection

Presentation for the

Huntingdon Area School District

November 20, 2017



Introduction

Trina Gribble, Assoc. AIA, LEED AP
McKissick Associates, School Planning Specialist

Our Charge

Provide the District with an analysis of existing building utilization patterns as well as updated enrollment projection modeling.

Facilitate a community discussion relative to future configuration possibilities with the goal of freeing up funding for 21st century programs, as well as offsetting budgetary challenges.

Develop and test fit possible options.

Provide a final presentation and provide support for ongoing discussions.

What do we know?

Enrollment has and will continue to decline.

PlanCon Aid is most likely gone for the foreseeable future. MA predicts PlanCon program will not be restored and if it is will not afford local Districts such as Huntingdon with substantial funding as in the past.

Nature of instruction is changing to a more technology oriented model than in the past.

Educational Programs

Curriculum

Special Programs

- STEM
- Extensive Special Education opportunities (20%)
 - Learning Support
 - Life Skills
 - Emotional Support
 - Speech Therapy
 - Occupational Therapy
 - ESL
 - 504
 - Gifted

Curriculum

Special Programs (continued)

- STEPS (Alt Ed 6-12)
- Pre-K – non-district program run by others, full day
- Head Start – non-district program run by others, full day
- Free and Reduced Lunch (48%)
- Breakfast Program (10-20%)
- Backpack Program – run by others

Curriculum

Current program changes

- Continue to implement 1:1 devices vs Computer Labs
- Desired growth in the Arts

Initiatives

- Library transformation into 21st century space
 - 24/7 Hub of engagement
 - Mass Customized Learning
 - STEM Maker Space
 - Learning Collaboration Lab
 - Video

Special Education Needs

Southside Elementary

- Teachers/Room needs
 - Learning Support Teacher(s) 2.5
 - Emotional Support Teacher(s) 1
 - Speech Therapy 1 room
 - Occupational Therapy ½ room
 - ESL ½ room
 - Gifted Teacher(s) 1

Total:

- 4.5 instructors
- 2.5 itinerant spaces

Special Education Needs

Standing Stone Elementary

- Teachers/Room needs
 - Life Skills 2 rooms
 - Sensory Room 1 room
 - Learning Support Teacher(s) 2.5
 - Emotional Support Teacher(s) 2
 - Speech Therapy 1 room
 - Occupational Therapy 1 room
 - De-escalation room 1 room
 - ESL ½ room
 - Gifted Teacher(s) 1

Total:

- 7.5 instructors
- 2.5 itinerant spaces

Special Education Needs

Middle School

- Teachers/Room needs
 - Life Skills Teacher(s) 1
 - Sensory Room 1 room
 - Learning Support Teacher(s) 5
 - Emotional Support Teacher(s) 1
 - Speech Therapy 1 room
 - Occupational Therapy 1 room
 - De-escalation room 1 room
 - ESL Teacher ½ (split w/ HS)
 - Gifted Teacher(s) 1

Total:

- 7 instructors
- 3 itinerant spaces

Special Education Needs

High School

- Teachers/Room needs
 - Life Skills Teacher(s) 1
 - Learning Support Teacher(s) 6
 - Emotional Support Teacher(s) 1
 - Speech Therapy 1 room
 - Occupational Therapy 1 room
 - De-escalation room 1 room
 - ESL Teacher ½ (split w/ HS)
 - Gifted Teacher(s) 1

Total:

- 9 instructors
- 2 itinerant spaces

The Enrollment Picture

Births by School District Municipality

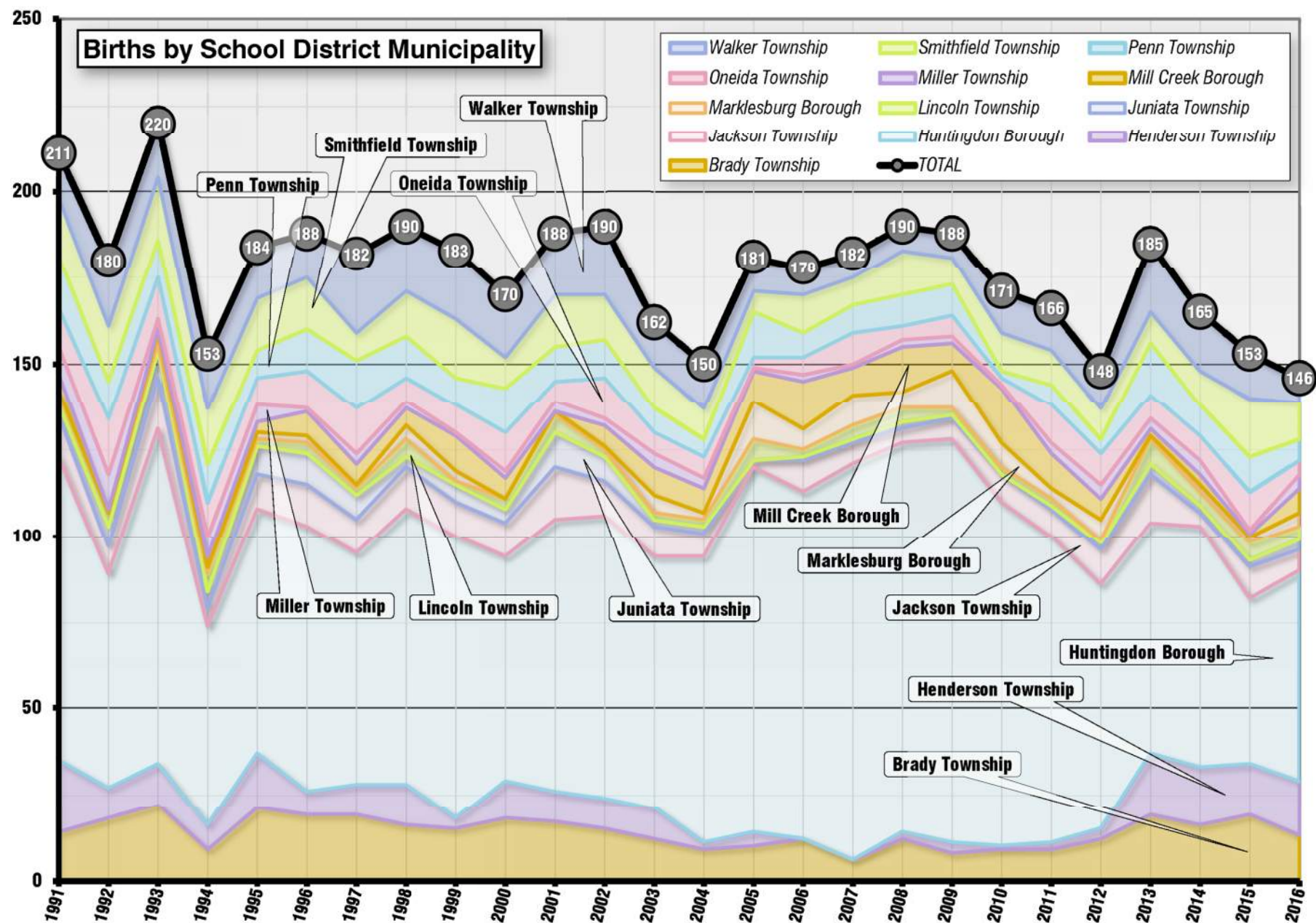

Births by School District Municipality

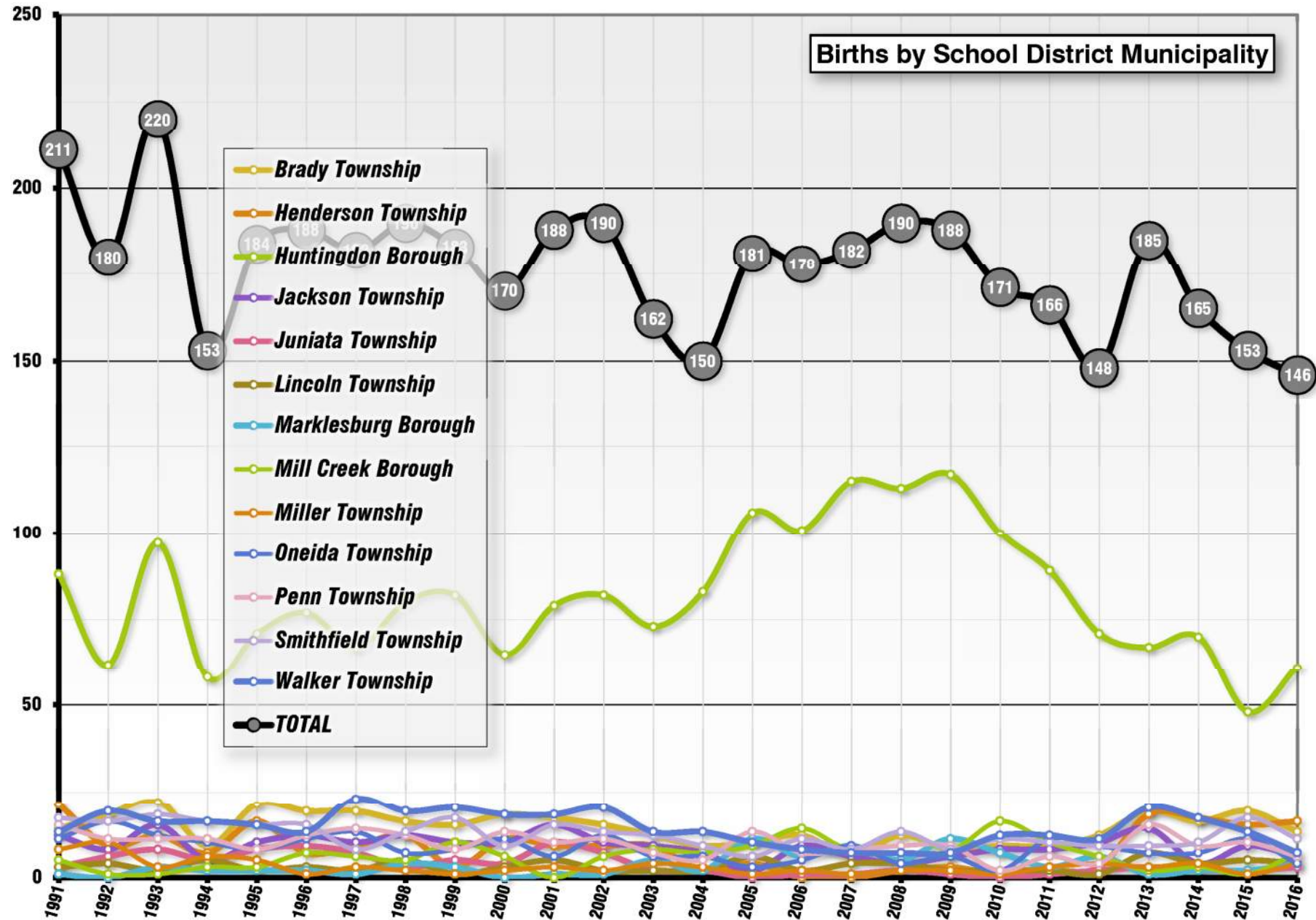

Birth Projections (All Municipalities)

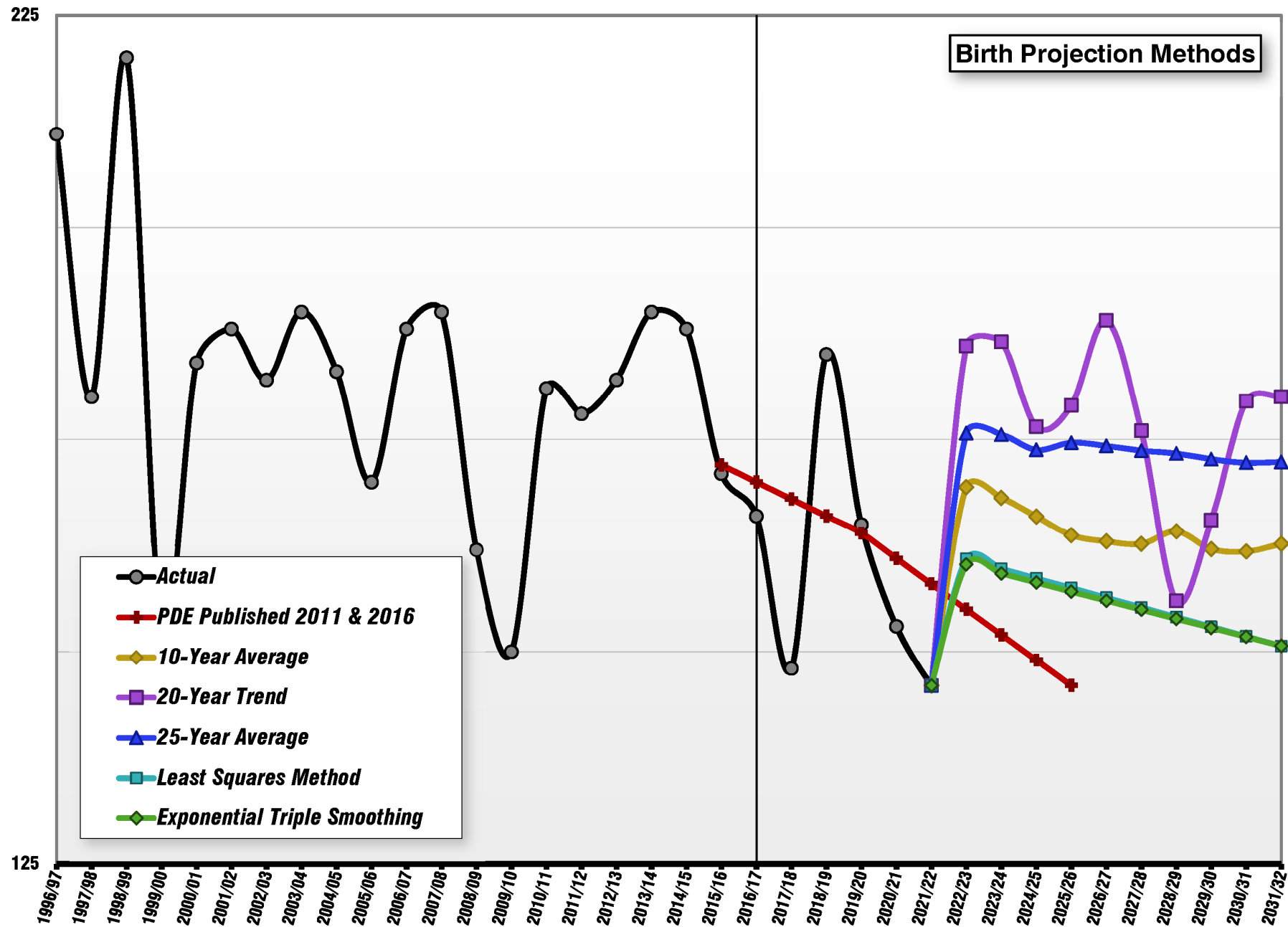

Enrollment History

| School Year | Birth Year | Birth | PK | K | 1 | 2 | 3 | 4 | 5 | 6 | 7 | 8 | 9 | 10 | 11 | 12 | Total |
|-------------|------------|-------|----|-----|-----|-----|-----|-----|-----|-----|-----|-----|-----|-----|-----|-----|-------|
| 1992/93 | 1987 | | | | | | | | | | | | | | | | |
| 1993/94 | 1988 | | | | | | | | | | | | | | | | 2,516 |
| 1994/95 | 1989 | | | | | | | | | | | | | | | | 2,494 |
| 1995/96 | 1990 | | | | | | | | | | | | | | | | 2,500 |
| 1996/97 | 1991 | 211 | | | | | | | | | | | | | | | 2,583 |
| 1997/98 | 1992 | 180 | | | | | | | | | | | | | | | 2,570 |
| 1998/99 | 1993 | 220 | | | | | | | | | | | | | | | 2,593 |
| 1999/00 | 1994 | 153 | | | | | | | | | | | | | | | 2,603 |
| 2000/01 | 1995 | 184 | | | | | | | | | | | | | | | 2,526 |
| 2001/02 | 1996 | 188 | | | | | | | | | | | | | | | 2,489 |
| 2002/03 | 1997 | 182 | | | | | | | | | | | | | | | 2,473 |
| 2003/04 | 1998 | 190 | | | | | | | | | | | | | | | 2,395 |
| 2004/05 | 1999 | 183 | | 168 | 148 | 156 | 164 | 159 | 181 | 188 | 184 | 197 | 223 | 217 | 175 | 167 | 2,327 |
| 2005/06 | 2000 | 170 | 4 | 159 | 172 | 144 | 155 | 163 | 167 | 180 | 178 | 184 | 207 | 208 | 204 | 166 | 2,291 |
| 2006/07 | 2001 | 188 | 3 | 168 | 163 | 165 | 146 | 156 | 163 | 171 | 181 | 177 | 208 | 182 | 204 | 192 | 2,279 |
| 2007/08 | 2002 | 190 | | 176 | 160 | 155 | 166 | 141 | 153 | 163 | 165 | 188 | 175 | 197 | 187 | 196 | 2,222 |
| 2008/09 | 2003 | 162 | | 150 | 178 | 166 | 161 | 174 | 145 | 152 | 157 | 179 | 201 | 171 | 187 | 182 | 2,203 |
| 2009/10 | 2004 | 150 | | 131 | 145 | 177 | 162 | 159 | 178 | 140 | 158 | 162 | 182 | 180 | 167 | 184 | 2,125 |
| 2010/11 | 2005 | 181 | | 138 | 132 | 146 | 178 | 158 | 160 | 172 | 147 | 153 | 170 | 177 | 187 | 164 | 2,082 |
| 2011/12 | 2006 | 178 | | 157 | 136 | 126 | 139 | 165 | 166 | 158 | 174 | 158 | 157 | 169 | 174 | 184 | 2,063 |
| 2012/13 | 2007 | 182 | | 146 | 159 | 138 | 129 | 142 | 172 | 170 | 158 | 171 | 161 | 151 | 153 | 168 | 2,018 |
| 2013/14 | 2008 | 190 | | 150 | 146 | 157 | 141 | 127 | 137 | 175 | 165 | 160 | 176 | 148 | 141 | 147 | 1,970 |
| 2014/15 | 2009 | 188 | | 159 | 146 | 150 | 149 | 138 | 129 | 144 | 170 | 162 | 154 | 167 | 149 | 150 | 1,967 |
| 2015/16 | 2010 | 171 | | 139 | 148 | 158 | 147 | 151 | 143 | 143 | 131 | 170 | 154 | 153 | 162 | 145 | 1,944 |
| 2016/17 | 2011 | 166 | | 123 | 136 | 144 | 160 | 147 | 151 | 145 | 138 | 136 | 172 | 149 | 161 | 161 | 1,923 |
| 2017/18 | 2012 | 148 | | 127 | 121 | 129 | 145 | 168 | 150 | 153 | 136 | 132 | 131 | 167 | 144 | 160 | 1,863 |

Enrollment Retention Rates

Annual Retention Ratios

| Retention Between Years | Birth | Birth | Birth | Birth | K | 1 | 2 | 3 | 4 | 5 | 6 | 7 | 8 | 9 | 10 | 11 |
|-------------------------|---------|---------|---------|---------|---------|---------|---------|---------|---------|---------|---------|---------|---------|---------|---------|---------|
| | to | to | to | to | to | to | to | to | to | to | to | to | to | to | to | to |
| | K | 1 | 2 | 3 | 1 | 2 | 3 | 4 | 5 | 6 | 7 | 8 | 9 | 10 | 11 | 12 |
| 2006/07 to 2007/08 | 0.92632 | 0.85106 | 0.91176 | 0.90710 | 0.95238 | 0.95092 | 1.00606 | 0.96575 | 0.98077 | 1.00000 | 0.96491 | 1.03867 | 0.98870 | 0.94712 | 1.02747 | 0.96078 |
| 2007/08 to 2008/09 | 0.92593 | 0.93684 | 0.88298 | 0.94706 | 1.01136 | 1.03750 | 1.03871 | 1.04819 | 1.02837 | 0.99346 | 0.96319 | 1.08485 | 1.06915 | 0.97714 | 0.94924 | 0.97326 |
| 2008/09 to 2009/10 | 0.87333 | 0.89506 | 0.93158 | 0.86170 | 0.96667 | 0.99438 | 0.97590 | 0.98758 | 1.02299 | 0.96552 | 1.03947 | 1.03185 | 1.01676 | 0.89552 | 0.97661 | 0.98396 |
| 2009/10 to 2010/11 | 0.76243 | 0.88000 | 0.90123 | 0.93684 | 1.00763 | 1.00690 | 1.00565 | 0.97531 | 1.00629 | 0.96629 | 1.05000 | 0.96835 | 1.04938 | 0.97253 | 1.03889 | 0.98204 |
| 2010/11 to 2011/12 | 0.88202 | 0.75138 | 0.84000 | 0.85802 | 0.98551 | 0.95455 | 0.95205 | 0.92697 | 1.05063 | 0.98750 | 1.01163 | 1.07483 | 1.02614 | 0.99412 | 0.98305 | 0.98396 |
| 2011/12 to 2012/13 | 0.80220 | 0.89326 | 0.76243 | 0.86000 | 1.01274 | 1.01471 | 1.02381 | 1.02158 | 1.04242 | 1.02410 | 1.00000 | 0.98276 | 1.01899 | 0.96178 | 0.90533 | 0.96552 |
| 2012/13 to 2013/14 | 0.78947 | 0.80220 | 0.88202 | 0.77901 | 1.00000 | 0.98742 | 1.02174 | 0.98450 | 0.96479 | 1.01744 | 0.97059 | 1.01266 | 1.02924 | 0.91925 | 0.93377 | 0.96078 |
| 2013/14 to 2014/15 | 0.84574 | 0.76842 | 0.82418 | 0.83708 | 0.97333 | 1.02740 | 0.94904 | 0.97872 | 1.01575 | 1.05109 | 0.97143 | 0.98182 | 0.96250 | 0.94886 | 1.00676 | 1.06383 |
| 2014/15 to 2015/16 | 0.81287 | 0.78723 | 0.83158 | 0.80769 | 0.93082 | 1.08219 | 0.98000 | 1.01342 | 1.03623 | 1.10853 | 0.90972 | 1.00000 | 0.95062 | 0.99351 | 0.97006 | 0.97315 |
| 2015/16 to 2016/17 | 0.74096 | 0.79532 | 0.76596 | 0.84211 | 0.97842 | 0.97297 | 1.01266 | 1.00000 | 1.00000 | 1.01399 | 0.96503 | 1.03817 | 1.01176 | 0.96753 | 1.05229 | 0.99383 |
| 2016/17 to 2017/18 | 0.85811 | 0.72892 | 0.75439 | 0.77128 | 0.98374 | 0.94853 | 1.00694 | 1.05000 | 1.02041 | 1.01325 | 0.93793 | 0.95652 | 0.96324 | 0.97093 | 0.96644 | 0.99379 |

Multi-Year Averaged Retention Ratios

| | Birth to K | Birth to 1 | Birth to 2 | Birth to 3 | K to 1 | 1 to 2 | 2 to 3 | 3 to 4 | 4 to 5 | 5 to 6 | 6 to 7 | 7 to 8 | 8 to 9 | 9 to 10 | 10 to 11 | 11 to 12 |
|-------------------------|------------|------------|------------|------------|---------|---------|---------|---------|---------|---------|---------|---------|---------|---------|----------|----------|
| One Year | 0.85811 | 0.72892 | 0.75439 | 0.77128 | 0.98374 | 0.94853 | 1.00694 | 1.05000 | 1.02041 | 1.01325 | 0.93793 | 0.95652 | 0.96324 | 0.97093 | 0.96644 | 0.99379 |
| 2 Year Average | 0.79954 | 0.76212 | 0.76018 | 0.80670 | 0.98108 | 0.96075 | 1.00980 | 1.02500 | 1.01021 | 1.01362 | 0.95148 | 0.99735 | 0.98750 | 0.96923 | 1.00937 | 0.99381 |
| 3 Year Average | 0.80398 | 0.77049 | 0.78398 | 0.80703 | 0.96433 | 1.00123 | 0.99987 | 1.02114 | 1.01888 | 1.04526 | 0.93756 | 0.99823 | 0.97521 | 0.97732 | 0.99626 | 0.98692 |
| 4 Year Average | 0.81442 | 0.76997 | 0.79403 | 0.81454 | 0.96658 | 1.00777 | 0.98716 | 1.01054 | 1.01810 | 1.04672 | 0.94603 | 0.99413 | 0.97203 | 0.97021 | 0.99889 | 1.00615 |
| 5 Year Average [PA DoE] | 0.80943 | 0.77642 | 0.81163 | 0.80743 | 0.97326 | 1.00370 | 0.99408 | 1.00533 | 1.00744 | 1.04086 | 0.95094 | 0.99783 | 0.98347 | 0.96002 | 0.98586 | 0.99708 |
| 7 Year Average | 0.81877 | 0.78953 | 0.80865 | 0.82217 | 0.98065 | 0.99825 | 0.99232 | 0.99646 | 1.01860 | 1.03084 | 0.96662 | 1.00668 | 0.99464 | 0.96514 | 0.97396 | 0.99069 |
| 3 Year Weighted Average | 0.81152 | 0.76077 | 0.77111 | 0.80096 | 0.97315 | 0.97895 | 1.00436 | 1.02724 | 1.01624 | 1.02938 | 0.94226 | 0.99098 | 0.97731 | 0.97356 | 0.99566 | 0.99036 |
| 5 Year Weighted Average | 0.81160 | 0.76844 | 0.79073 | 0.80674 | 0.97143 | 0.99489 | 0.99634 | 1.01548 | 1.01380 | 1.03783 | 0.94616 | 0.99411 | 0.97796 | 0.96815 | 0.99326 | 0.99681 |
| 7 Year Weighted Average | 0.81267 | 0.77960 | 0.79793 | 0.81262 | 0.97554 | 0.99801 | 0.99591 | 1.00913 | 1.01489 | 1.03613 | 0.95405 | 0.99751 | 0.98458 | 0.96572 | 0.98397 | 0.99421 |
| 4 Year Rolling Average | 0.85811 | 0.72892 | 0.75439 | 0.77128 | 0.98374 | 0.94853 | 1.00694 | 1.05000 | 1.02041 | 1.01325 | 0.93793 | 0.95652 | 0.96324 | 0.97093 | 0.96644 | 0.99379 |
| 7 Year Rolling Average | 0.85811 | 0.72892 | 0.75439 | 0.77128 | 0.98374 | 0.94853 | 1.00694 | 1.05000 | 1.02041 | 1.01325 | 0.93793 | 0.95652 | 0.96324 | 0.97093 | 0.96644 | 0.99379 |

Enrollment Projection Method Comparison

Enrollment Projection Comparison

| School Year | Enrollment History | DoE Projections (Published + Cohort) 5 Year Average [PA Dept. of Ed.] Retention from Births for K-1 | Linear Forecast Series (10-Year) 5 Year Weighted Average Retention from Births for K-1 | Linear Forecast Series (15-Year) 4 Year Rolling Average Retention from Births for K-1 | 15-Year Trend 5 Year Weighted Average Retention from Births for K-1 | Least Squares Method (20-Year) 7 Year Weighted Average Retention from Births for K-1 | Exponential Triple Smoothing (25-Year) 7 Year Rolling Average Retention from Births for K-1 | Exponential Triple Smoothing (25-Year) 5 Year Weighted Average Retention from Births for K-1 | Average of Methods without Migration |
|-------------|--------------------|---|--|---|---|--|---|--|--------------------------------------|
| 2013/14 | 1,970 | | | | | | | | |
| 2014/15 | 1,967 | | | | | | | | |
| 2015/16 | 1,944 | | | | | | | | |
| 2016/17 | 1,923 | | | | | | | | |
| 2017/18 | 1,863 | 1,863 | 1,863 | 1,863 | 1,863 | 1,863 | 1,863 | 1,863 | 1,863 |
| 2018/19 | | 1,831 | 1,832 | 1,828 | 1,832 | 1,832 | 1,831 | 1,832 | 1,831 |
| 2019/20 | | 1,806 | 1,805 | 1,798 | 1,805 | 1,810 | 1,805 | 1,805 | 1,805 |
| 2020/21 | | 1,755 | 1,748 | 1,737 | 1,748 | 1,756 | 1,754 | 1,748 | 1,749 |
| 2021/22 | | 1,742 | 1,724 | 1,706 | 1,724 | 1,736 | 1,734 | 1,724 | 1,727 |
| 2022/23 | | 1,727 | 1,702 | 1,691 | 1,727 | 1,726 | 1,724 | 1,714 | 1,716 |
| 2023/24 | | 1,707 | 1,673 | 1,672 | 1,709 | 1,713 | 1,707 | 1,699 | 1,697 |
| 2024/25 | | 1,679 | 1,633 | 1,646 | 1,691 | 1,690 | 1,685 | 1,675 | 1,671 |
| 2025/26 | | 1,644 | 1,590 | 1,610 | 1,682 | 1,664 | 1,661 | 1,648 | 1,643 |
| 2026/27 | | 1,590 | 1,527 | 1,554 | 1,658 | 1,619 | 1,619 | 1,606 | 1,596 |
| 2027/28 | | 1,554 | 1,479 | 1,515 | 1,655 | 1,594 | 1,596 | 1,578 | 1,567 |
| 2028/29 | | 1,532 | 1,439 | 1,487 | 1,670 | 1,582 | 1,586 | 1,566 | 1,552 |
| 2029/30 | | 1,514 | 1,406 | 1,467 | 1,684 | 1,579 | 1,583 | 1,562 | 1,542 |
| 2030/31 | | 1,501 | 1,380 | 1,458 | 1,699 | 1,580 | 1,583 | 1,566 | 1,538 |
| 2031/32 | | 1,457 | 1,324 | 1,421 | 1,678 | 1,552 | 1,557 | 1,541 | 1,504 |
| 2032/33 | | 1,426 | 1,277 | 1,396 | 1,678 | 1,538 | 1,545 | 1,528 | 1,484 |
| 2033/34 | | 1,395 | 1,237 | 1,375 | 1,694 | 1,531 | 1,541 | 1,523 | 1,471 |
| 2034/35 | | 1,363 | 1,197 | 1,360 | 1,702 | 1,528 | 1,542 | 1,523 | 1,459 |
| 2035/36 | | 1,334 | 1,155 | 1,334 | 1,681 | 1,514 | 1,531 | 1,512 | 1,437 |
| 2036/37 | | 1,304 | 1,113 | 1,306 | 1,684 | 1,501 | 1,520 | 1,502 | 1,419 |
| 2037/38 | | 1,276 | 1,071 | 1,278 | 1,685 | 1,486 | 1,510 | 1,490 | 1,399 |

Enrollment Projection Method Comparison

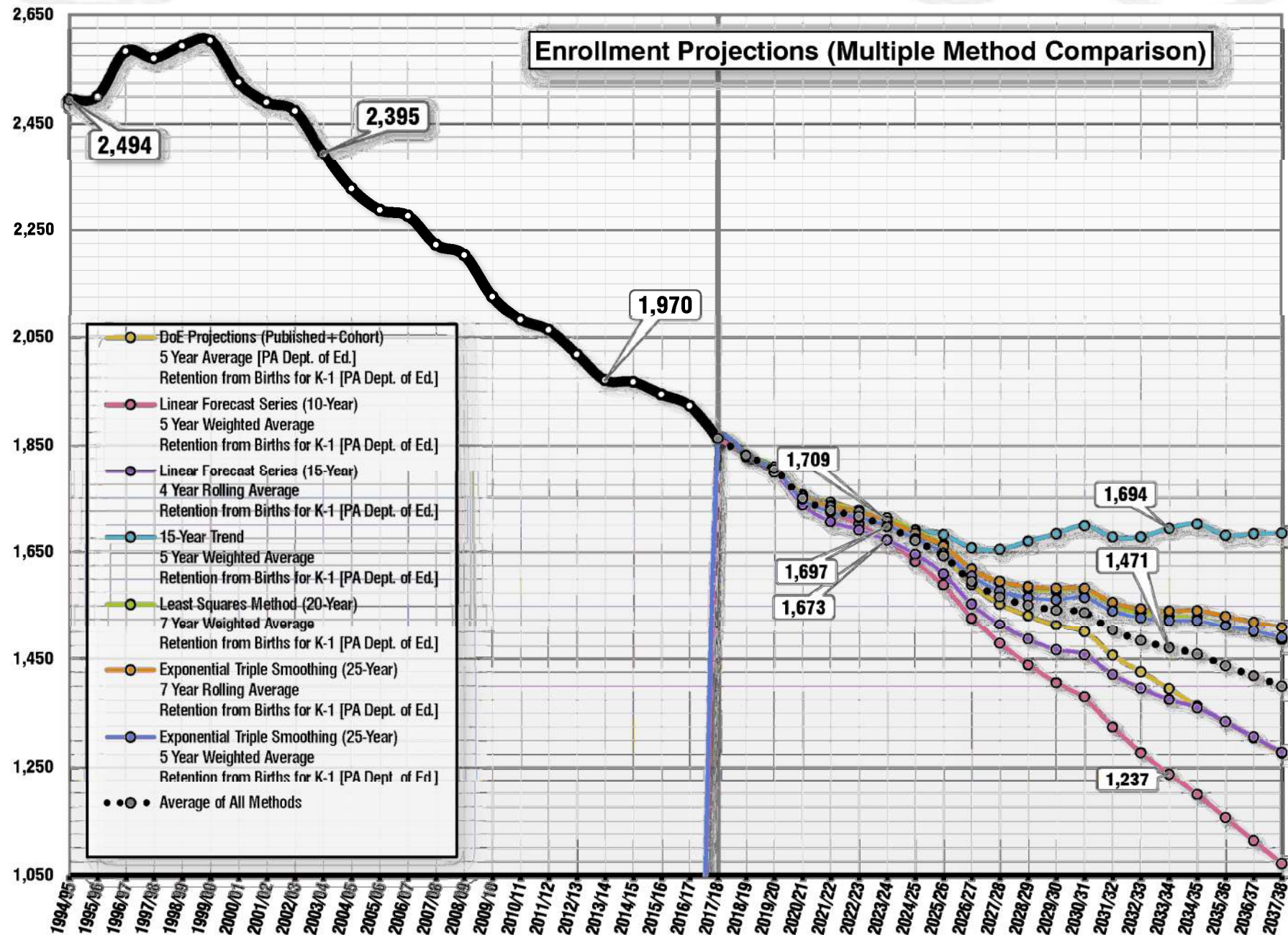

Enrollment Projections (Average of All Methods)

| School Year | | K | 1 | 2 | 3 | 4 | 5 | 6 | 7 | 8 | 9 | 10 | 11 | 12 | Total |
|-------------|--|-----|-----|-----|-----|-----|-----|-----|-----|-----|-----|-----|-----|-----|-------|
| 2012/13 | | 146 | 159 | 138 | 129 | 142 | 172 | 170 | 158 | 171 | 161 | 151 | 153 | 168 | 2,018 |
| 2013/14 | | 150 | 146 | 157 | 141 | 127 | 137 | 175 | 165 | 160 | 176 | 148 | 141 | 147 | 1,970 |
| 2014/15 | | 159 | 146 | 150 | 149 | 138 | 129 | 144 | 170 | 162 | 154 | 167 | 149 | 150 | 1,967 |
| 2015/16 | | 139 | 148 | 158 | 147 | 151 | 143 | 143 | 131 | 170 | 154 | 153 | 162 | 145 | 1,944 |
| 2016/17 | | 123 | 136 | 144 | 160 | 147 | 151 | 145 | 138 | 136 | 172 | 149 | 161 | 161 | 1,923 |
| 2017/18 | | 127 | 121 | 129 | 145 | 168 | 150 | 153 | 136 | 132 | 131 | 167 | 144 | 160 | 1,863 |
| 2018/19 | | 150 | 114 | 120 | 129 | 147 | 170 | 156 | 145 | 135 | 129 | 127 | 165 | 143 | 1,831 |
| 2019/20 | | 134 | 143 | 113 | 120 | 130 | 149 | 176 | 148 | 144 | 133 | 125 | 126 | 164 | 1,805 |
| 2020/21 | | 125 | 127 | 142 | 113 | 122 | 132 | 154 | 167 | 147 | 141 | 128 | 124 | 125 | 1,749 |
| 2021/22 | | 120 | 119 | 126 | 141 | 115 | 124 | 137 | 146 | 166 | 144 | 137 | 127 | 123 | 1,727 |
| 2022/23 | | 129 | 114 | 118 | 126 | 143 | 117 | 128 | 130 | 145 | 163 | 139 | 136 | 127 | 1,716 |
| 2023/24 | | 126 | 122 | 113 | 118 | 128 | 145 | 121 | 122 | 129 | 143 | 157 | 138 | 135 | 1,697 |
| 2024/25 | | 125 | 119 | 122 | 113 | 120 | 130 | 150 | 114 | 121 | 127 | 138 | 156 | 137 | 1,671 |
| 2025/26 | | 125 | 119 | 118 | 121 | 115 | 122 | 135 | 143 | 114 | 118 | 123 | 136 | 155 | 1,643 |
| 2026/27 | | 124 | 119 | 118 | 118 | 123 | 117 | 126 | 128 | 142 | 111 | 114 | 121 | 136 | 1,596 |
| 2027/28 | | 122 | 117 | 118 | 118 | 120 | 125 | 121 | 120 | 127 | 139 | 107 | 113 | 121 | 1,567 |

Enrollment Projections (Average of All Methods)

| School Year | ELEM | MIDDLE | HIGH | | ELEM | MIDDLE | HIGH | | ELEM | MIDDLE | HIGH | | ELEM | MIDDLE | HIGH | K-12 |
|--------------------|---------|---------|---------|--|--------|---------|---------|--|--------|---------|---------|--|---------|---------|---------|---------|
| | K-5 | 6-8 | 9-12 | | K-2 | 3-6 | 7-12 | | K-3 | 4-6 | 7-12 | | K-4 | 5-8 | 9-12 | |
| 2015/16 | 886 | 444 | 614 | | 445 | 584 | 915 | | 592 | 437 | 915 | | 743 | 587 | 614 | 1,944 |
| 2016/17 | 861 | 419 | 643 | | 403 | 603 | 917 | | 563 | 443 | 917 | | 710 | 570 | 643 | 1,923 |
| 2017/18 | 840 | 421 | 602 | | 377 | 616 | 870 | | 522 | 471 | 870 | | 690 | 571 | 602 | 1,863 |
| 2018/19 | 831 | 436 | 564 | | 385 | 602 | 845 | | 514 | 473 | 845 | | 661 | 606 | 564 | 1,831 |
| 2019/20 | 789 | 468 | 547 | | 390 | 576 | 839 | | 510 | 455 | 839 | | 641 | 617 | 547 | 1,805 |
| 2020/21 | 762 | 468 | 519 | | 394 | 522 | 833 | | 508 | 409 | 833 | | 630 | 601 | 519 | 1,749 |
| 2021/22 | 746 | 450 | 532 | | 365 | 518 | 844 | | 506 | 376 | 844 | | 622 | 574 | 532 | 1,727 |
| 2022/23 | 747 | 404 | 564 | | 361 | 515 | 840 | | 487 | 389 | 840 | | 630 | 521 | 564 | 1,716 |
| 2023/24 | 752 | 372 | 573 | | 361 | 512 | 824 | | 479 | 394 | 824 | | 607 | 517 | 573 | 1,697 |
| 2024/25 | 729 | 386 | 557 | | 366 | 513 | 792 | | 479 | 400 | 792 | | 599 | 516 | 557 | 1,671 |
| 2025/26 | 720 | 391 | 532 | | 362 | 493 | 788 | | 483 | 371 | 788 | | 598 | 513 | 532 | 1,643 |
| 2026/27 | 718 | 396 | 483 | | 360 | 484 | 752 | | 478 | 366 | 752 | | 601 | 512 | 483 | 1,596 |
| 2027/28 | 720 | 367 | 480 | | 357 | 483 | 727 | | 475 | 366 | 727 | | 595 | 492 | 480 | 1,567 |
| MAX | 831 | 468 | 573 | | 394 | 602 | 845 | | 514 | 473 | 845 | | 661 | 617 | 573 | 1,831 |
| CURRENT + 10.0% | 924 | 463 | 662 | | 415 | 678 | 957 | | 574 | 518 | 957 | | 759 | 628 | 662 | 2,049 |
| GREATER | 924 | 468 | 662 | | 415 | 678 | 957 | | 574 | 518 | 957 | | 759 | 628 | 662 | 2,049 |
| 2017-2028 | - 120 | - 54 | - 122 | | - 20 | - 133 | - 143 | | - 47 | - 105 | - 143 | | - 95 | - 79 | - 122 | - 296 |
| % Change | -14.27% | -12.79% | -20.27% | | -5.23% | -21.52% | -16.49% | | -9.00% | -22.35% | -16.49% | | -13.77% | -13.79% | -20.27% | -15.87% |

Enrollment Projections

Historic Projection Comparison

Previous Study

| | | | | |
|-----------------|------------|------------|------------|--------------|
| • 2008/09: | K-5 | 6-8 | 9-12 | Total |
| 2008 Study | 961 | 487 | 726 | 2,174 |
| PDE Reported | 974 | 488 | 741 | 2,203 |
| • 2016/17: | K-5 | 6-8 | 9-12 | Total |
| 2008 Projected | 970 | 445 | 644 | 2,059 |
| PDE Reported | 861 | 419 | 643 | 1,923 |
| • 2016/17: | K-5 | 6-8 | 9-12 | Total |
| October 1, 2017 | 840 | 421 | 602 | 1,863 |

Projection Comparison for 2028/29

| <i>Projection</i> | <i>Students</i> | <i>Change</i> |
|----------------------|-----------------|---------------|
| • Highest Projection | 1,670 | - 10.4 % |
| • Lowest Projection | 1,439 | - 22.8 % |
| • Average Projection | 1,552 | - 16.7 % |

Total Enrollment Decrease from 2006/07 was 22.2 %

- Average annual enrollment change for the past 10 years: - 1.8 %
- Average annual enrollment change projected next 10 years: - 1.6 %

School District Municipalities:

- Henderson Township
- Huntingdon Borough
- Jackson Township
- Juniata Township
- Lincoln Township
- Marklesburg Borough
- Mill Creek Borough
- Miller Township
- Oneida Township
- Penn Township
- Smithfield Township
- Walker Township

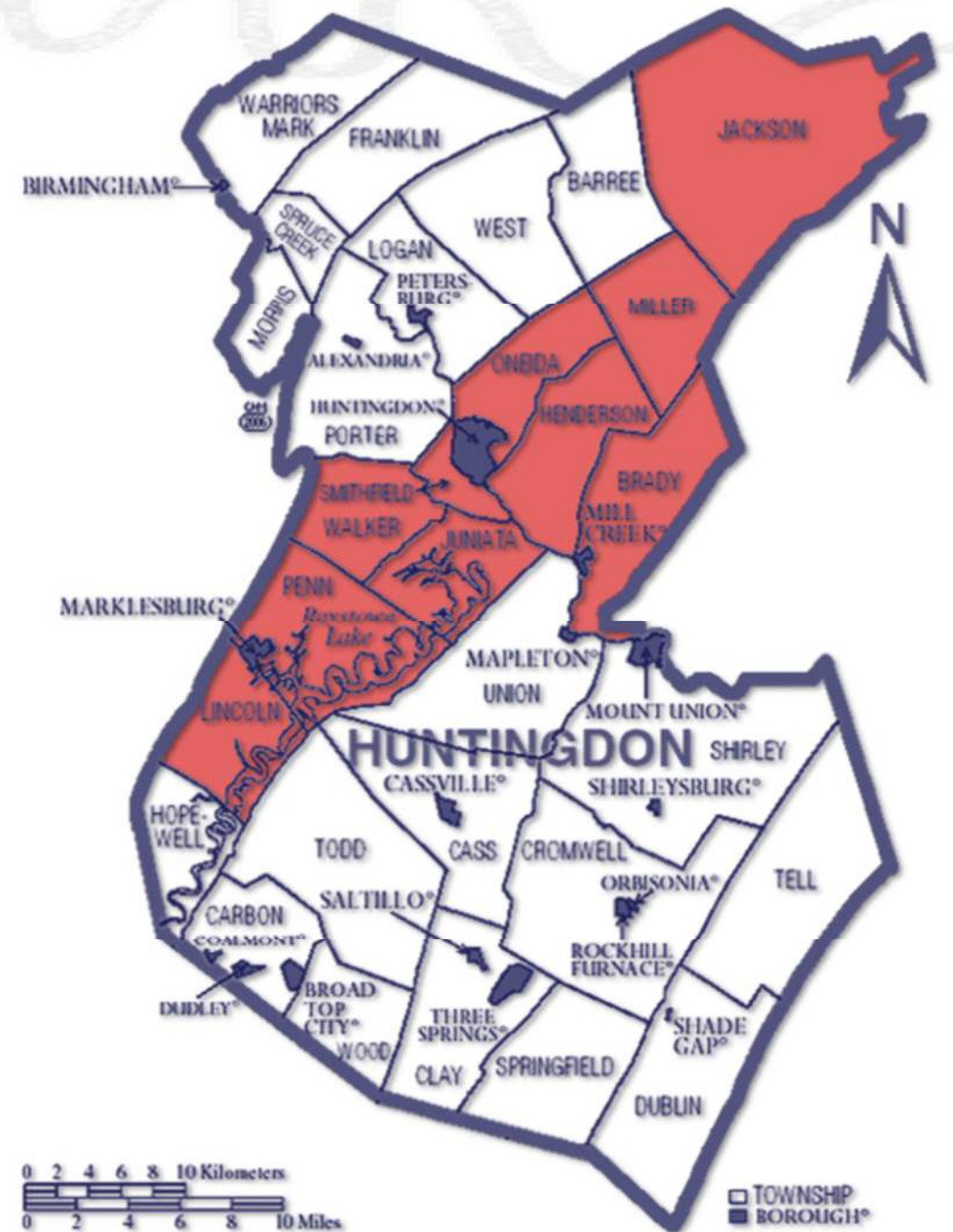

Municipalities Census Data

- 2010 Census – total population 20,447
- 2018 Census Est. – total population 20,351

Municipality Development

Walker Township

- Victoria Heights - 20 units to be sold
- Victoria Heights – Phase 2 - 40 units
- 6-8 Duplexes or Quads

Total potential of 68 units will have a negligible impact on K-12 student enrollment

Current Non-Public School Enrollments

| | |
|-------------------|------------|
| • Private Schools | 138 |
| • Charter Schools | 89 |
| Total | 227 |

Potential Impact on Public System

| | |
|--|--------------|
| • Likely Projection for 2027/28 public enrollment | 1,567 |
| • Development (negligible) | 0 |
| • Total Possible Non-Public School Closure Impact (unlikely) | 227 |
| | 1,794 |

The Buildings

Southside Elementary

Site Plan





Southside Elementary**General Observations**

- Built 1997
- Total Area 60,271 SF
- Capacity FTE: 525
 - 19 K-5 classrooms FTE: 475
 - 1 Title 1 classroom FTE: 25
 - 2 Special Ed resource rooms FTE: 25
- Replacement value \$ 13,727,806

Fair to Good Condition

- Slab movement
 - In 2016, Keller Engineers recommended to continue monitoring.
- Yard drainage improvements - recent
- Roof project pending (membrane)

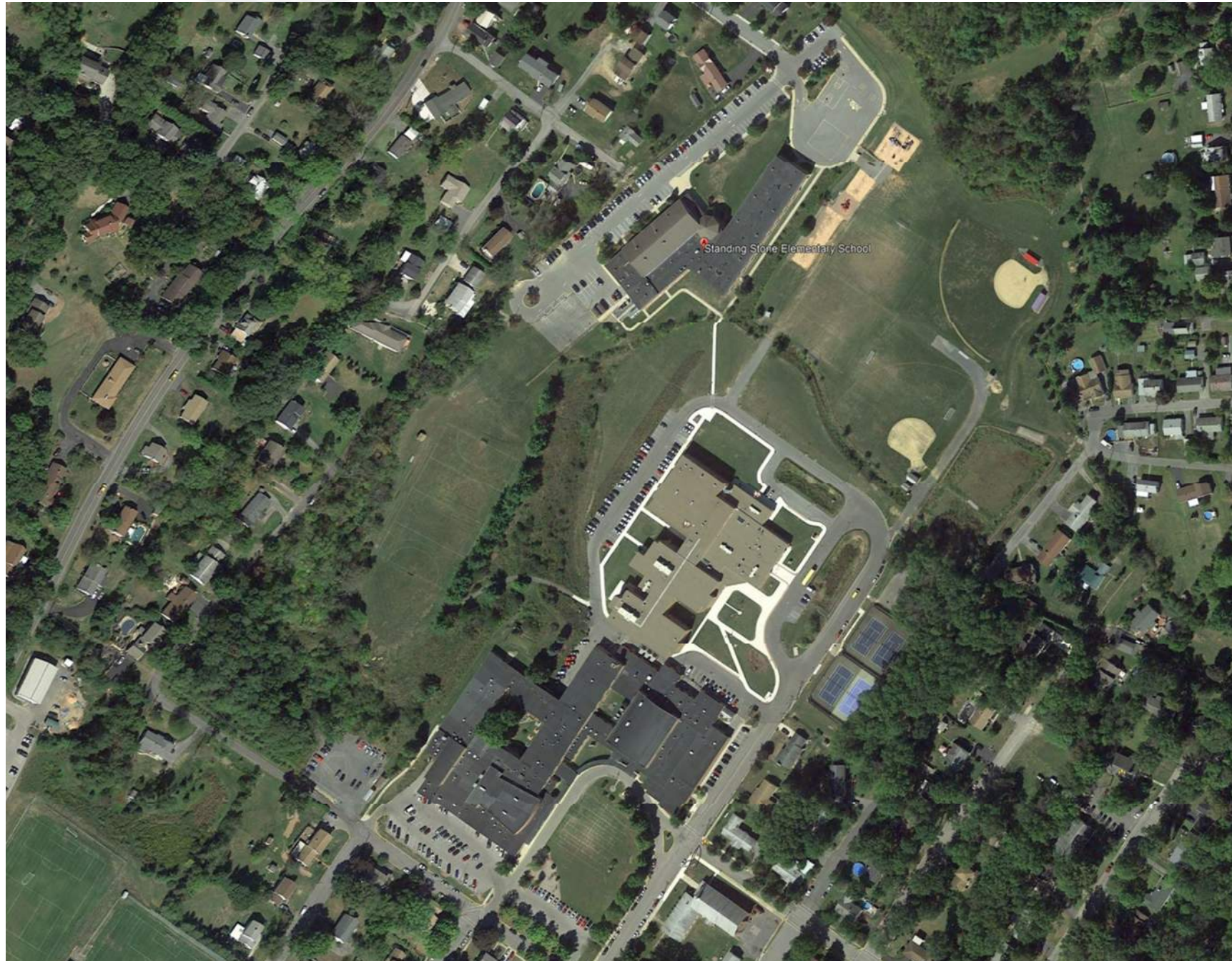

Standing Stone Elementary

Site Plan



Standing Stone Elementary

Plan, Ground Floor

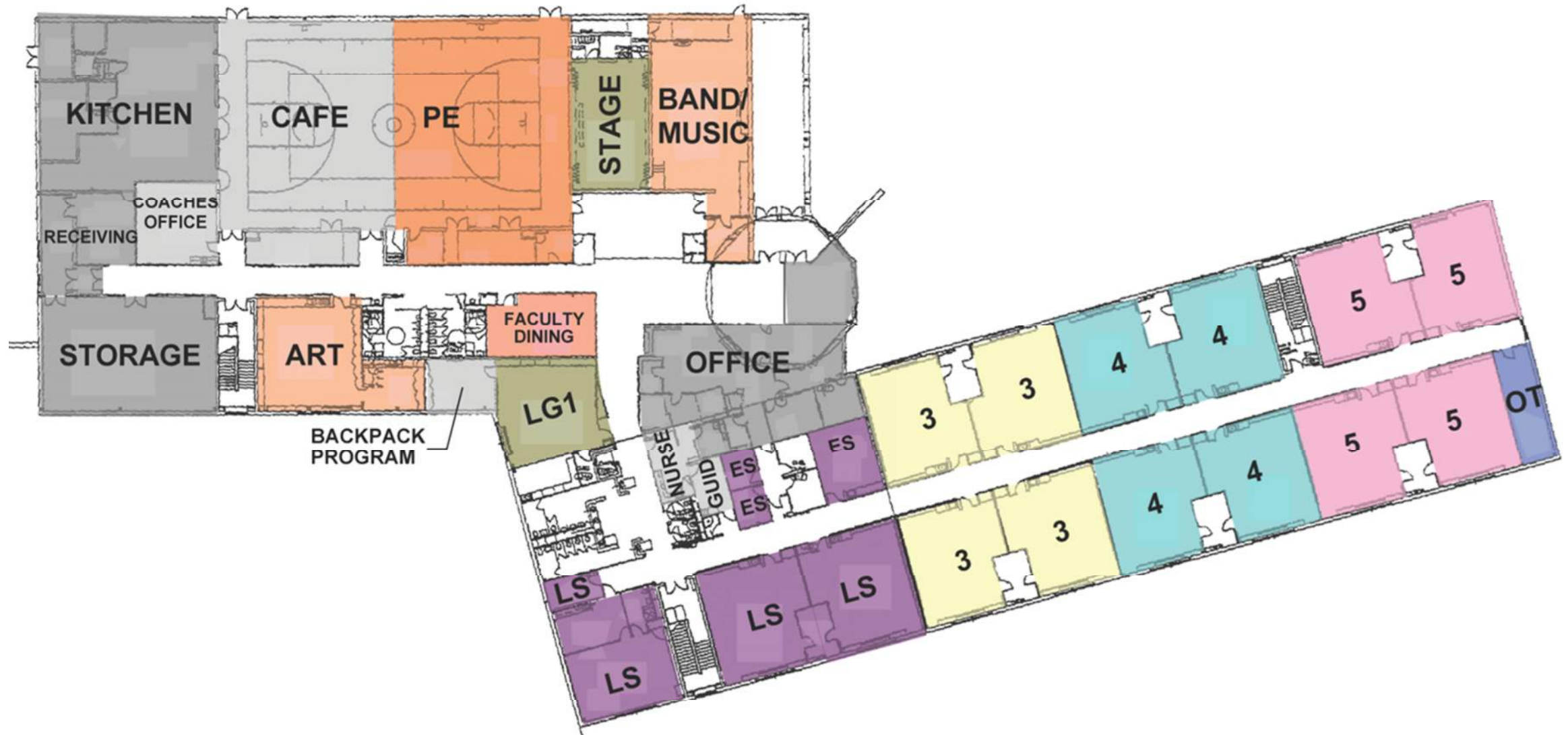

Standing Stone Elementary

Plan, First Floor

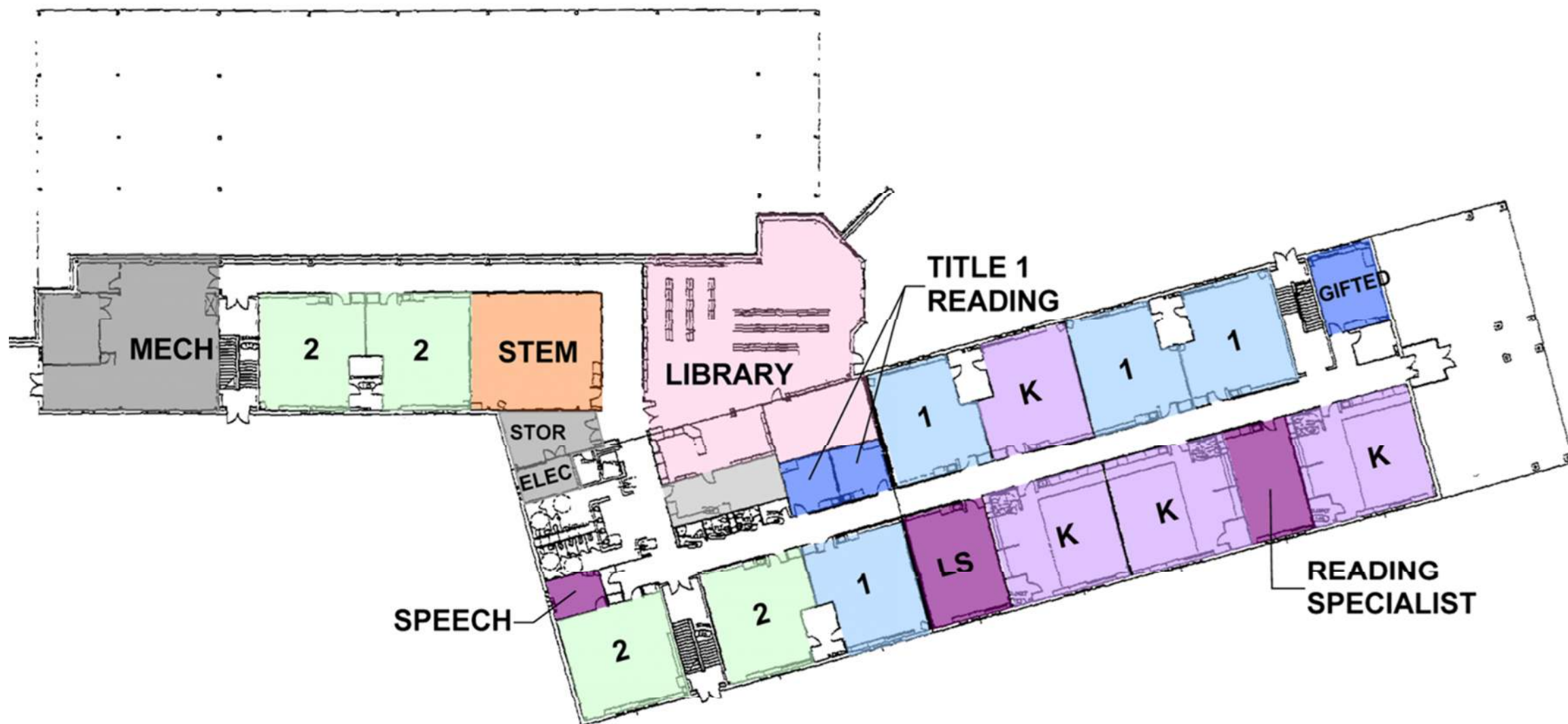

Standing Stone Elementary**General Observations**

- Built 2000
- Total Area: 78,516 SF
- Capacity FTE: 700
 - 24 K-5 classrooms FTE: 600
 - 3 Special Ed classrooms FTE: 75
 - 5 Special Ed resource rooms FTE: 25
- Replacement value \$ 17,883,434

Good Condition

- Roof – 18 years old
 - Coating and installing metal shingles in summer 2018
- Chiller repairs - recent
- Dehumidification and air infiltration issues

Huntingdon Area Middle School

Site Plan



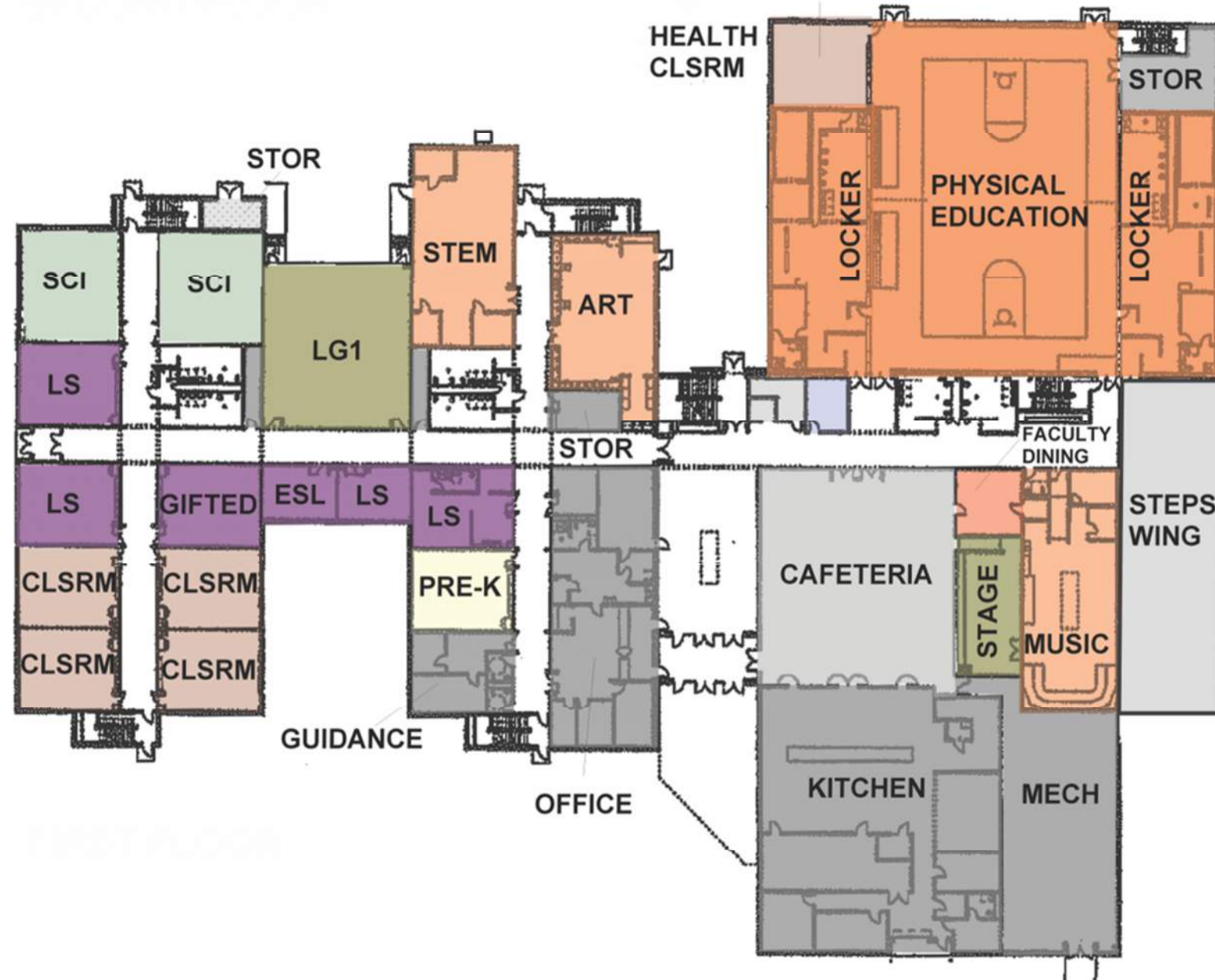

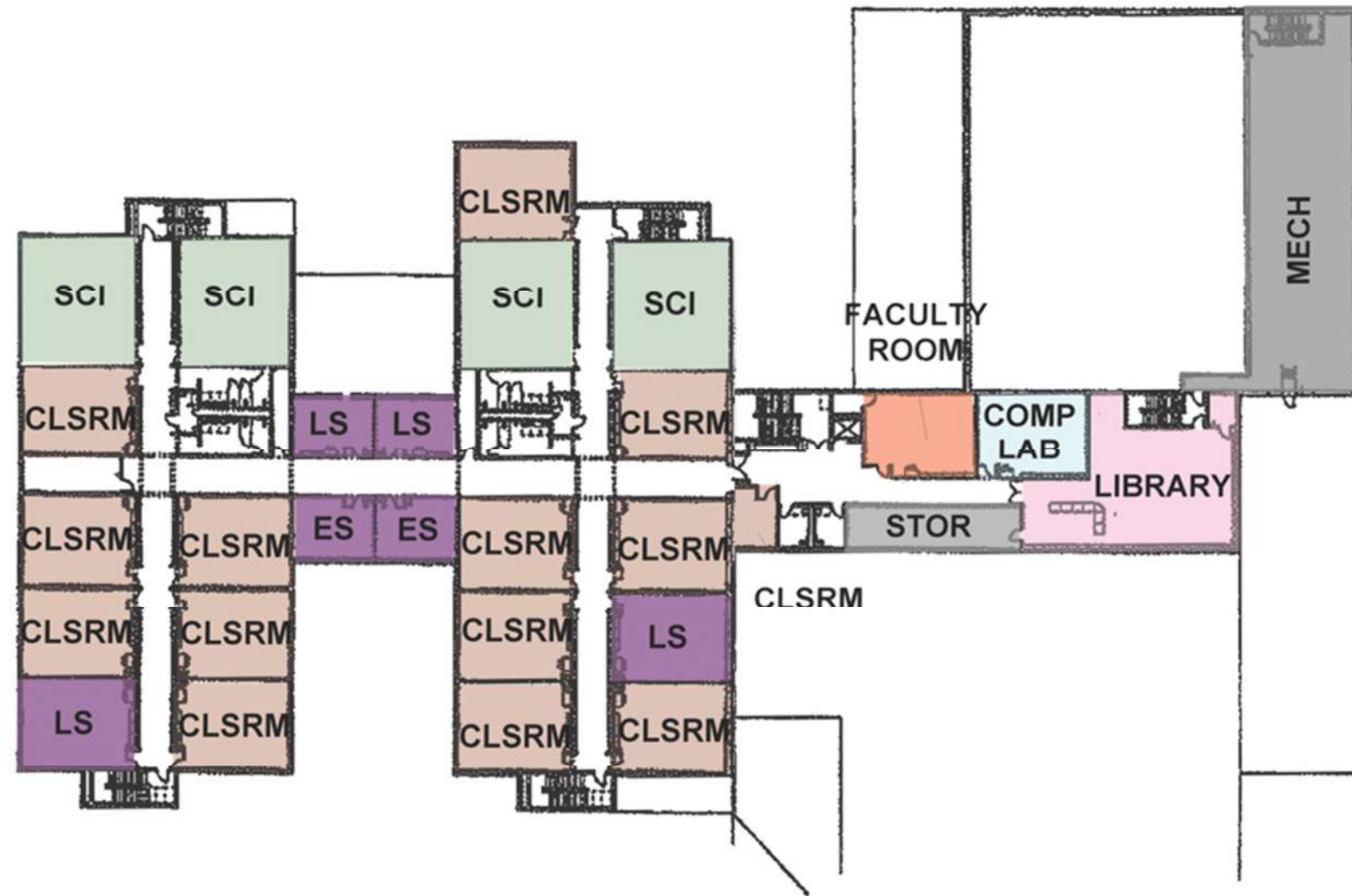

- Built 2012
- Total Area: 100,849 SF
- Capacity FTE: 926
 - 18 6-8 classrooms FTE: 450
 - 6 Science Labs FTE: 120
 - 1 Computer Lab FTE: 20
 - 1 Art classroom FTE: 20
 - 1 Music classroom FTE: 25
 - 1 STEM classroom FTE: 25
 - Gym FTE: 66
 - 6 Special Ed classrooms FTE: 150
 - 6 Special Ed resource rooms FTE: 25
 - 1 Pre-K classroom FTE: 25
- Replacement value \$22,791,652

Excellent Condition

Huntingdon Area High School

Site Plan



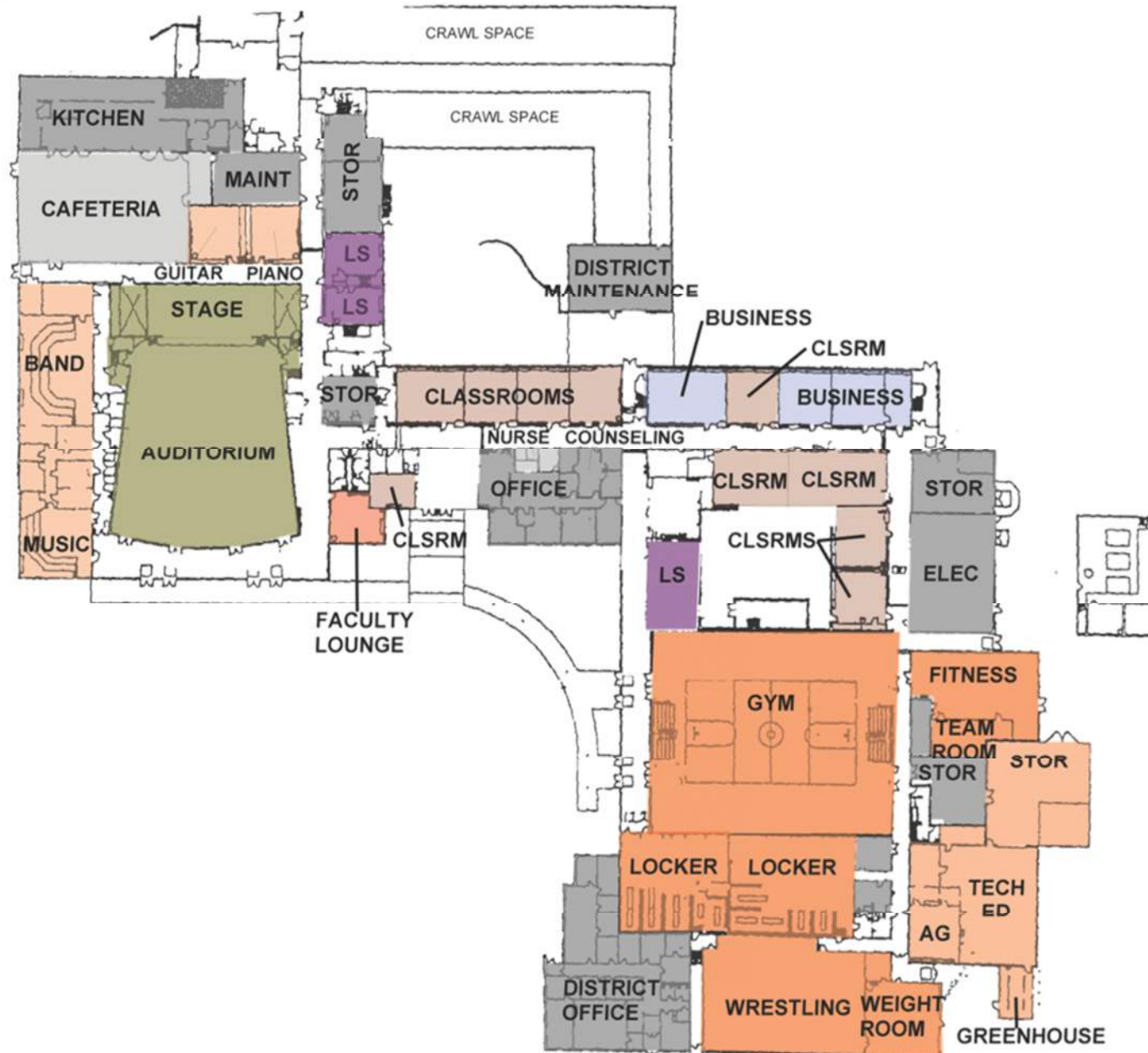

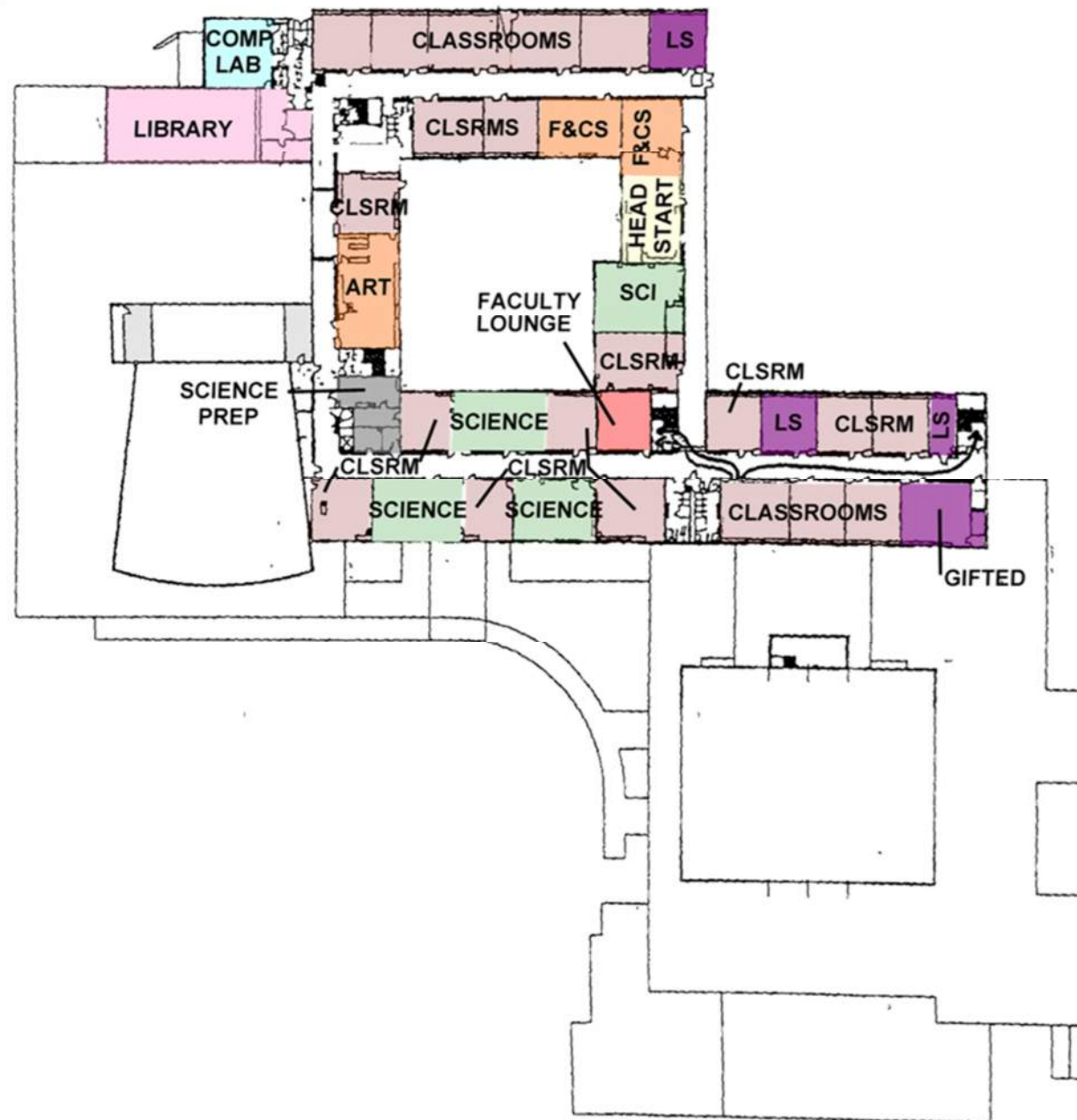

Huntingdon Area High School

General Observations

- Built 1960, renovated 2004
- Total Area: 141,380 SF
- Capacity FTE: 1,399
 - 24 general classrooms FTE: 600
 - 5 Science classrooms FTE: 125
 - 4 Science Labs FTE: 80
 - 3 Business classrooms FTE: 75
 - 1 Computer Lab FTE: 20
 - 1 Art classroom FTE: 20
 - 4 Music/Band classroom FTE: 100
 - 2 F&CS classrooms FTE: 40
 - 2 Tech Ed classrooms FTE: 40
 - Gym FTE: 66
 - Auxiliary Gym FTE: 33
 - 1 Head Start classroom FTE: 25
 - 6 Special Ed classrooms FTE: 150
 - 1 Special Ed resource rooms FTE: 25
- Replacement value \$ 31,951,569

Fair to Good condition

- Abated
- Roof – re-roofed 14 years ago
- Ceiling DX units in office – freeze up periodically

Food Service Facilities & Programs**General Observations****Southside Elementary School**

- Full prep kitchen – traditional service – good condition

Standing Stone Elementary School

- Full prep kitchen – traditional service – good condition

Middle School

- Full prep kitchen – food court style – good condition

High School

- Full prep kitchen – food court style – good condition

Conditions Assessment Matrix

Building Condition Ranking Based Upon Relative Assessments

| Facility | Year Built | Years of Additions | Age (Years) | Site (Including circulation/parking) | Exterior Envelope & Structural Systems | | Educational Support | Food Service | ADA Compliance | Building Code Compliance (IBC) | Energy Efficiency & IAQ | Heating, Ventilation & Air-Conditioning | Plumbing | Electrical | Fire Protection | Technology | Overall Assessment | | Relative Ranking |
|--------------------|------------|--------------------|-------------|--------------------------------------|--|------|---------------------|--------------|----------------|--------------------------------|-------------------------|---|----------|------------|-----------------|------------|--------------------|-----------|------------------|
| | | | | 5% | 24% | 5% | | | | | | | | | | | 10% | 2% | |
| Elementary Schools | | | | | | | | | | | | | | | | | | | |
| Southside | 1997 | | 20 | 4 | 1 | 4 | 3 | 4 | 4 | 3 | 3 | 3 | 3 | 3 | 3 | 2 | 2.65 | Good | 3 |
| Standing Stone | 2000 | | 17 | 3 | 3 | 4 | 4 | 4 | 4 | 3 | 3 | 3 | 3 | 3 | 3 | 2 | 3.18 | Good | 2 |
| Middle Schools | | | | | | | | | | | | | | | | | | | |
| Middle School | 2012 | | 5 | 3 | 4 | 4 | 4 | 4 | 4 | 3 | 3 | 3 | 4 | 3 | 4 | 2 | 3.51 | Excellent | 1 |
| High Schools | | | | | | | | | | | | | | | | | | | |
| High School | 1960 | 2004 | 57 | 2 | 3 | 3 | 3 | 3 | 4 | 3 | 3 | 2 | 2 | 2 | 2 | 2 | 2.60 | Good | 4 |
| Average | 31.2 | | 31.2 | 2.8 | 2.8 | 3.6 | 3.4 | 3.6 | 4.0 | 2.8 | 3.0 | 2.6 | 2.8 | 2.6 | 2.8 | 2.0 | 2.90 | | |
| Ranking Index | | | | | | | | | | | | | | | | | | | |
| 0 | | Missing | | 1 | | Poor | | 2 | | Fair | | 3 | | Good | | 4 | | Excellent | |

Conditions Assessment Graph

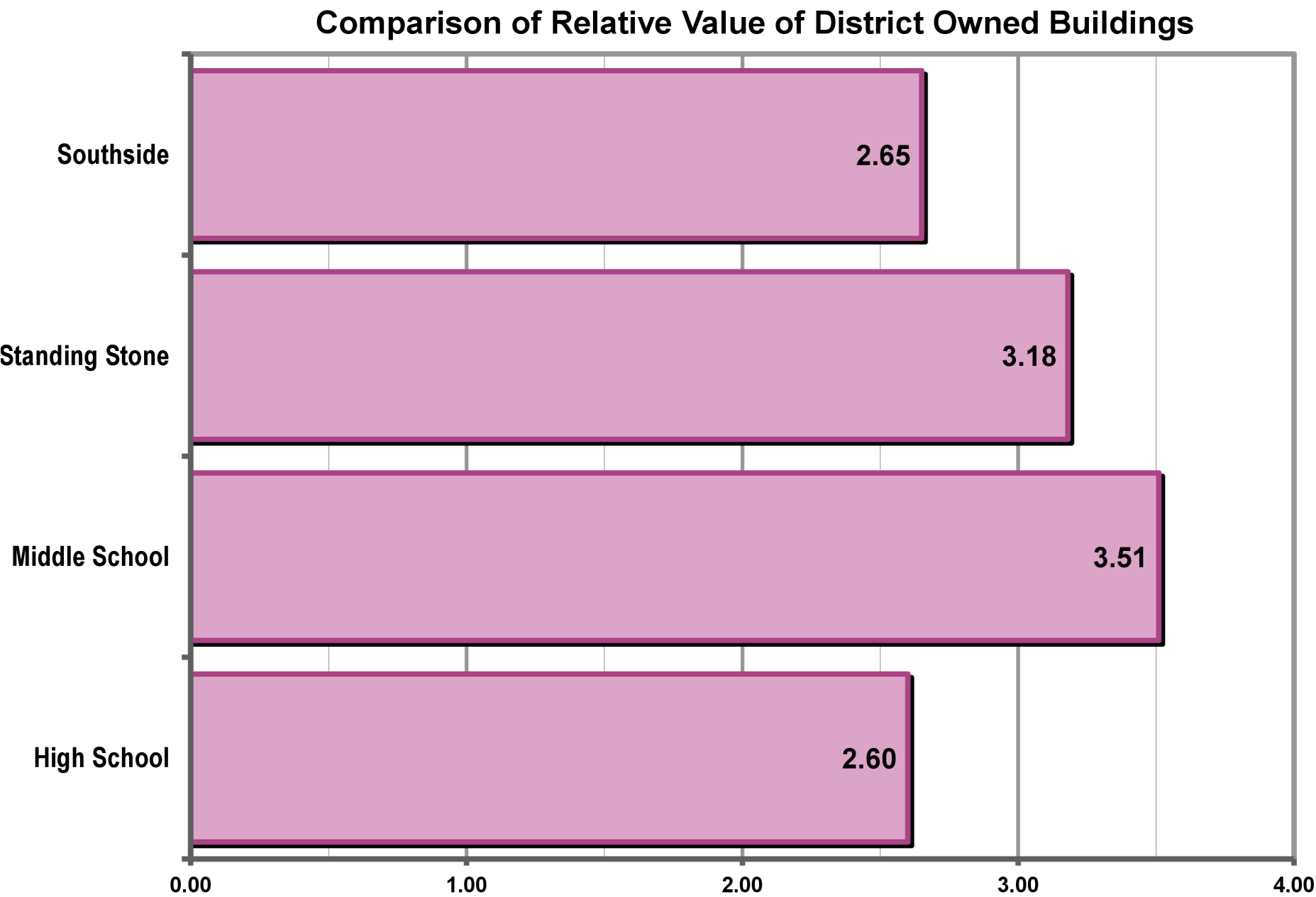

Energy Use Matrix

Average Energy Use

| Facility | Building Area | Gas | Sewer | Electric | Communications | Total per SF | | |
|--------------------|---------------|------------|-----------|------------|----------------|---------------|--------|--|
| | | | | | | Cost | /sf | |
| Elementary Schools | | | | | | | | |
| Southside | 60,271 SF | \$ 63,239 | \$ 21,650 | \$ 61,419 | \$ 6,698 | \$ 153,006.00 | \$2.54 | |
| Standing Stone | 78,516 SF | \$ 72,389 | \$ 21,600 | \$ 70,233 | \$ 2,852 | \$ 167,074.00 | \$2.13 | |
| Middle Schools | | | | | | | | |
| Middle School | 100,849 SF | \$ 82,020 | \$ 7,457 | \$ 79,928 | \$ 2,852 | \$ 172,257.00 | \$1.71 | |
| High Schools | | | | | | | | |
| High School | 141,380 SF | \$ 162,973 | \$ 20,389 | \$ 140,232 | \$ 2,852 | \$ 326,446.00 | \$2.31 | |
| Total | 381,016 SF | \$ 380,621 | \$ 71,096 | \$ 351,812 | \$ 15,254 | \$ 818,783.00 | \$2.15 | |

Energy Use Graph

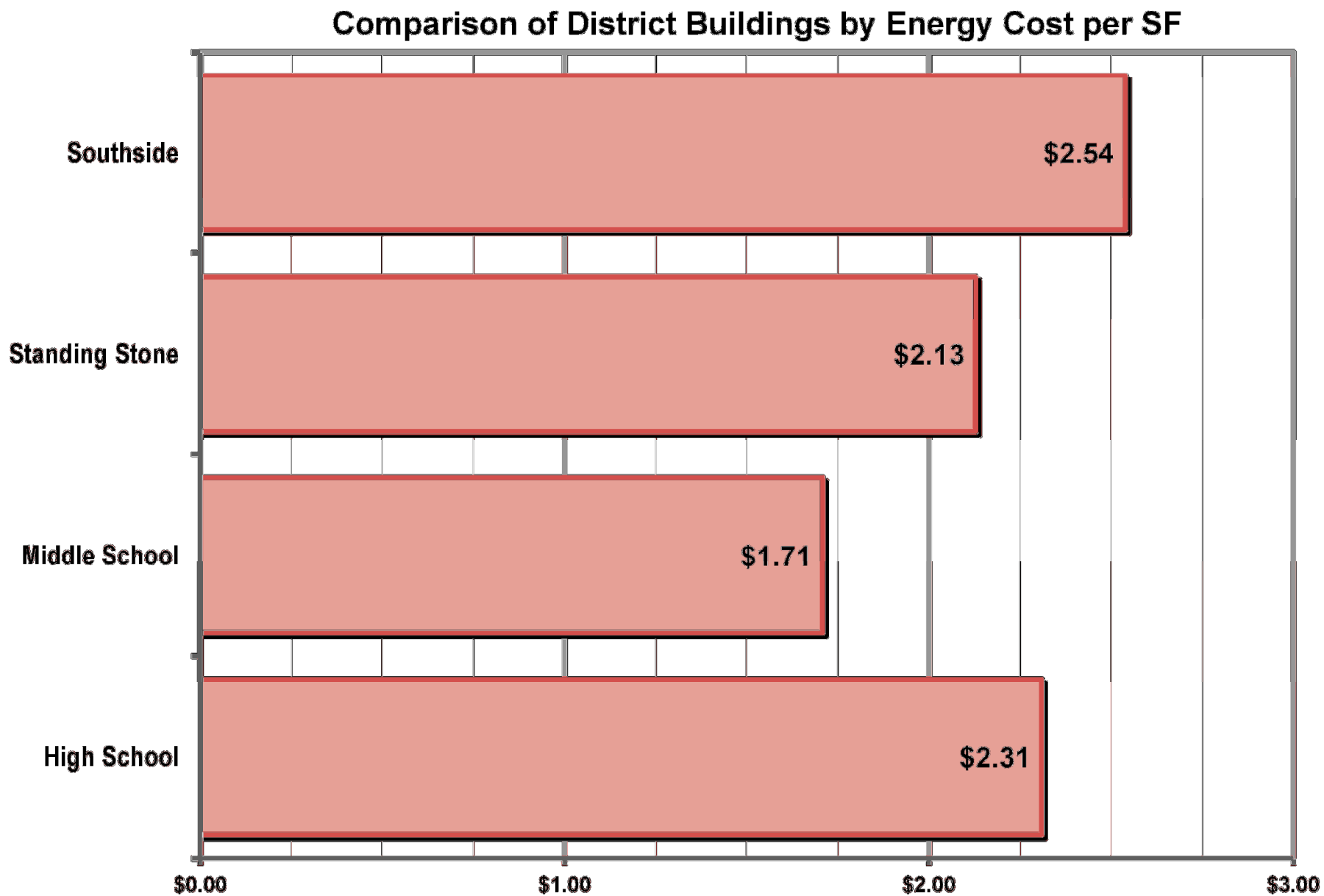

Capacity vs Enrollment

Capacity vs Enrollment

Historic Capacity

Previous 2009 Study:

| | |
|---------------------------------------|-----|
| • Brady-Henderson ES, 1998 renovation | 225 |
| • Jackson-Miller ES, 1998 renovation | 150 |
| • Southside ES, built 1996 | 425 |
| • Standing Stone ES, built 1998 | 575 |

Elementary FTE: 1,375

| | |
|--------------------------------|-------|
| • Old Middle School | 667 |
| • High School, 2004 renovation | 1,129 |

District Total: 3,171

Capacity vs Enrollment

Current Capacity

Current Capacity:

- Brady-Henderson, 1998 renovation 0 (closed)
- Jackson-Miller, 1998 renovation 0 (closed)
- Southside, built 1996 (*not including Special Ed*) 500
- Standing Stone, built 1998 (*not including Special Ed*) 600

Elementary FTE: 1,100

- Old Middle School 0 (closed)
- New Middle School, built 2011 (*not including Special Ed*) 751
- High School, 2004 renovation (*not including Special Ed*) 1,224

District Total: 3,075

PDE Capacity based on the following:

| | |
|--|---------------------------|
| • K to 2nd grade | 25 students per classroom |
| • 3rd to 12th grade | 25 students per classroom |
| • STEM | 25 students per classroom |
| • MS/HS Business, Computer and Science Labs | 20 students per classroom |
| • MS/HS IA, Tech Ed and F&CS | 20 students per classroom |
| • MS/HS Music, Band, Orchestra | 25 students per classroom |
| • MS/HS Art | 20 students per classroom |
| • MS/HS Gym | 66 students per 7500 SF |
| • MS/HS Auxiliary Gym | 33 students per station |
| • Learning Support and Gifted | 25 students per classroom |

Capacity vs Enrollment

Practical Capacity

Practical Capacity based on the following:

- K to 2nd grade
- 3rd to 12th grade
- STEM
- MS/HS Business, Computer and Science Labs
- MS/HS IA, Tech Ed and F&CS
- MS/HS Music, Band, Orchestra
- MS/HS Art
- MS/HS Gym
- MS/HS Auxiliary Gym
- Learning Support and Gifted

20 students per classroom

25 students per classroom

25 students per classroom

20 students per classroom

20 students per classroom

20 students per classroom

20 students per classroom

33 students per station

0 students per station

12 students per classroom

Capacity Versus Enrollment Chart

| Facility Name | Enrollment | Capacity | | Public Enrollment | | | | | Total District Enrollment |
|-------------------------------|--------------|--------------|--------------------|-------------------|-----------|-----------|------------|-----------|---------------------------|
| | | PDE Capacity | Practical Capacity | Regular Education | ESL | 504 | LS | Gifted | |
| Elementary Schools | 837 | 1,225 | 1,026 | | | | | | |
| Southside Elementary | 382 | 525 | 450 | 281 | 3 | 3 | 77 | 18 | 382 |
| Standing Stone Elementary | 455 | 700 | 576 | 336 | 3 | 3 | 92 | 21 | 455 |
| Middle Schools | 420 | 848 | 810 | | | | | | |
| Huntingdon Area Middle School | 420 | 848 | 810 | 309 | 3 | 3 | 85 | 20 | 420 |
| High Schools | 601 | 1,274 | 1,071 | | | | | | |
| Huntingdon Area High School | 601 | 1,274 | 1,071 | 443 | 5 | 4 | 121 | 28 | 601 |
| TOTAL | 1,858 | 3,348 | 2,907 | 1,369 | 14 | 13 | 375 | 87 | 1,858 |

Capacity Versus Enrollment Graph

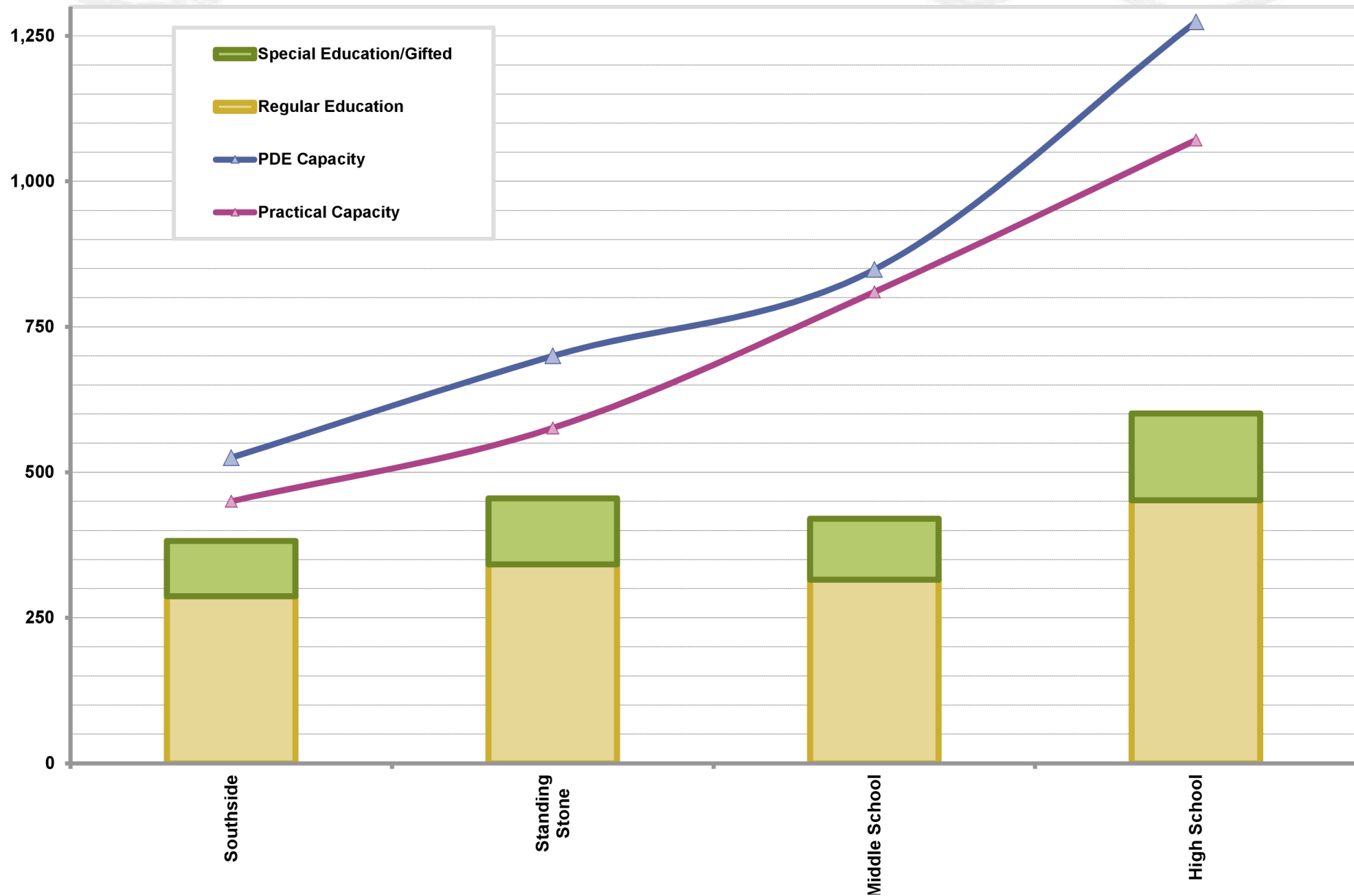

Utilization Chart

Building Utilization Summary

| Facility | Enrollment | Building Area (not including Natatorium or Dist. Garage) | Replacement Cost/SF | Current RE Enrollment (8/17) | Current ESL Enrollment (8/17) | Current 504 Enrollment (8/17) | Current SE Enrollment (8/17) | Current Gifted Enrollment | Total Building Enrollment * | Building Capacity (PDE) | Building Capacity (Practical) | Utilization Percentage | SF per Pupil* | Utilization Percentage (over/under) |
|---------------------------|------------|---|---------------------|------------------------------|----------------------------------|-------------------------------|------------------------------|---------------------------|-----------------------------|----------------------------|----------------------------------|------------------------|---------------|--|
| Elementary Schools | | | | | | | | | | | | | | |
| Southside | 382 | 60,271 SF | \$ 13,727,806 | 281 | 3 | 3 | 77 | 18 | 382 | 525 | 450 | 84.89% | 134 SF | 15.11% |
| Standing Stone | 455 | 78,516 SF | \$ 17,883,434 | 336 | 3 | 3 | 92 | 21 | 455 | 700 | 576 | 78.99% | 136 SF | 21.01% |
| Middle Schools | | | | | | | | | | | | | | |
| Middle School | 420 | 100,849 SF | \$ 22,791,652 | 309 | 3 | 3 | 85 | 20 | 420 | 848 | 810 | 51.85% | 125 SF | 48.15% |
| High Schools | | | | | | | | | | | | | | |
| High School | 601 | 141,380 SF | \$ 31,951,569 | 443 | 5 | 4 | 121 | 28 | 601 | 1,274 | 1,071 | 56.12% | 132 SF | 43.88% |
| Other Facilities | | | | | | | | | | | | | | |
| DAO | n/a | 0 SF | \$ - | | | | | | 0 | 0 | 0 | 0.00% | 0 SF | 100.00% |
| Total | | | | | | | | | | | | | | |
| | | 381,016 SF | \$ 86,354,460 | 1,369 | 14 | 13 | 375 | 87 | 1,858 | 3,348 | 2,907 | 55.50% | 114 SF | |

* PDE Target SF Per Pupil is 92 SF for Elementary and 123 SF Pupil for Secondary Grades

Utilization Graph

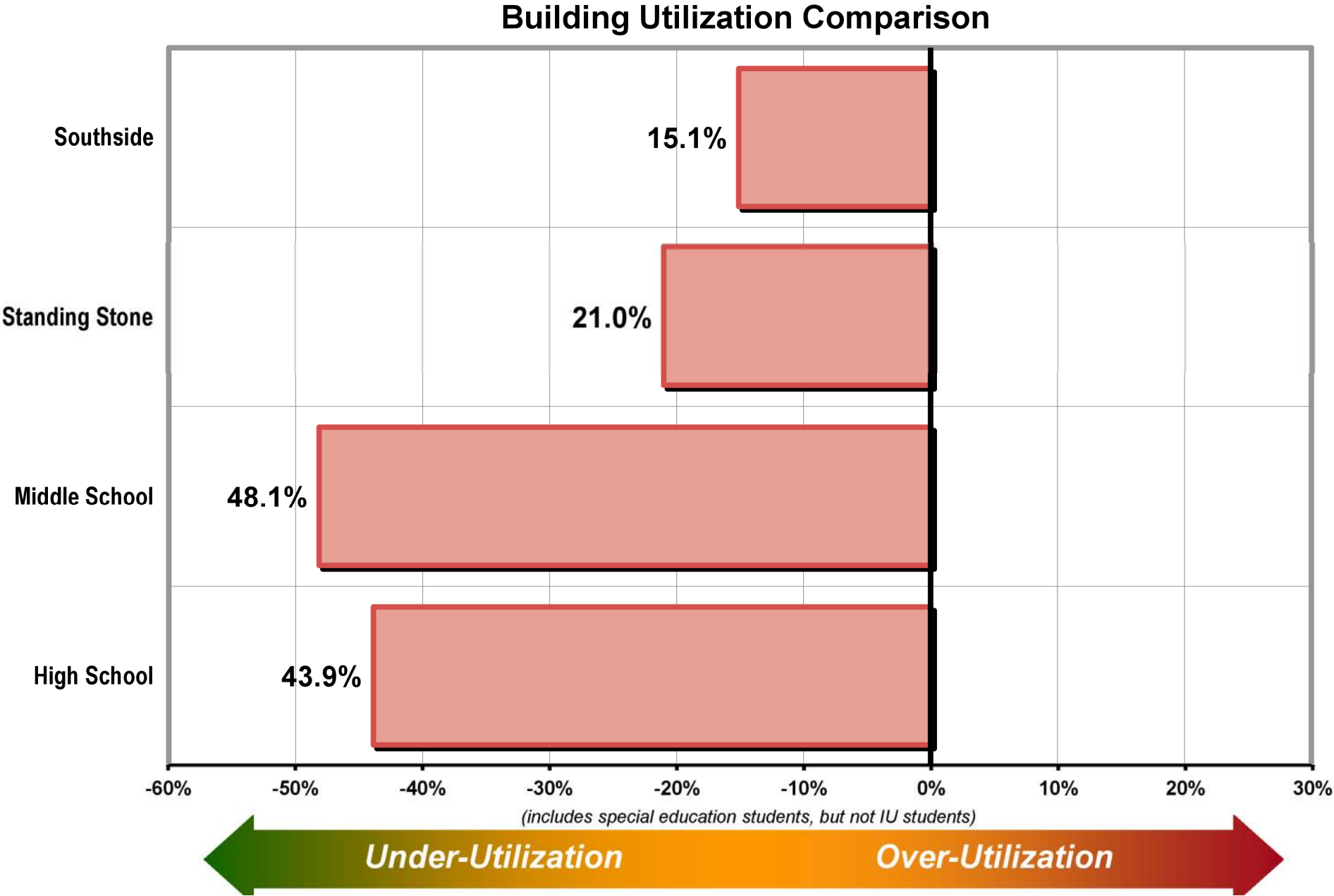

Survey Results

HASD Professional Staff Survey Summary

An online survey tool was employed and obtained responses from nearly 140 teaching staff.

Key points included...

Q2: How many years have you been an educator?

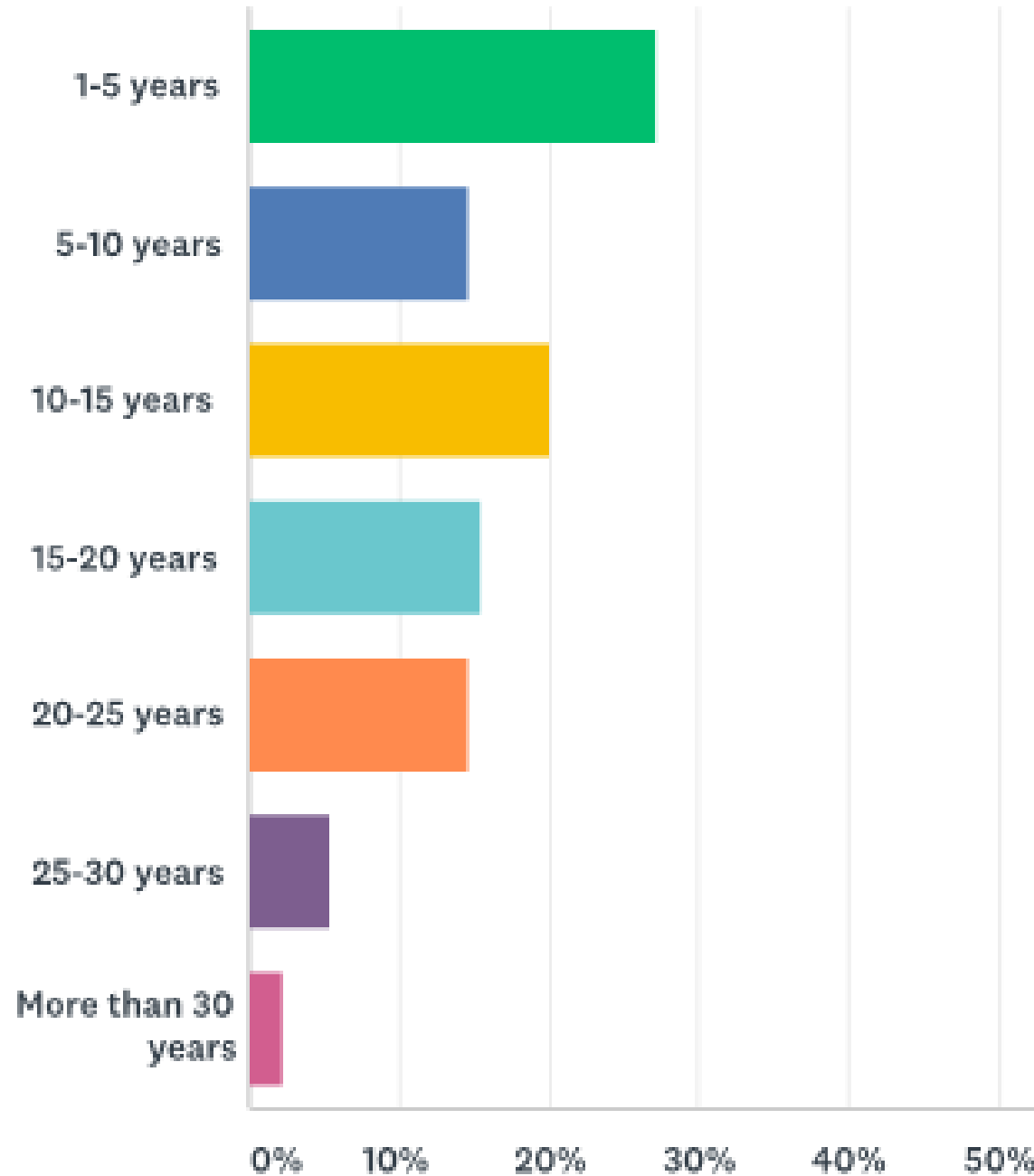

Q10: What do you think is the most appropriate grade organization?

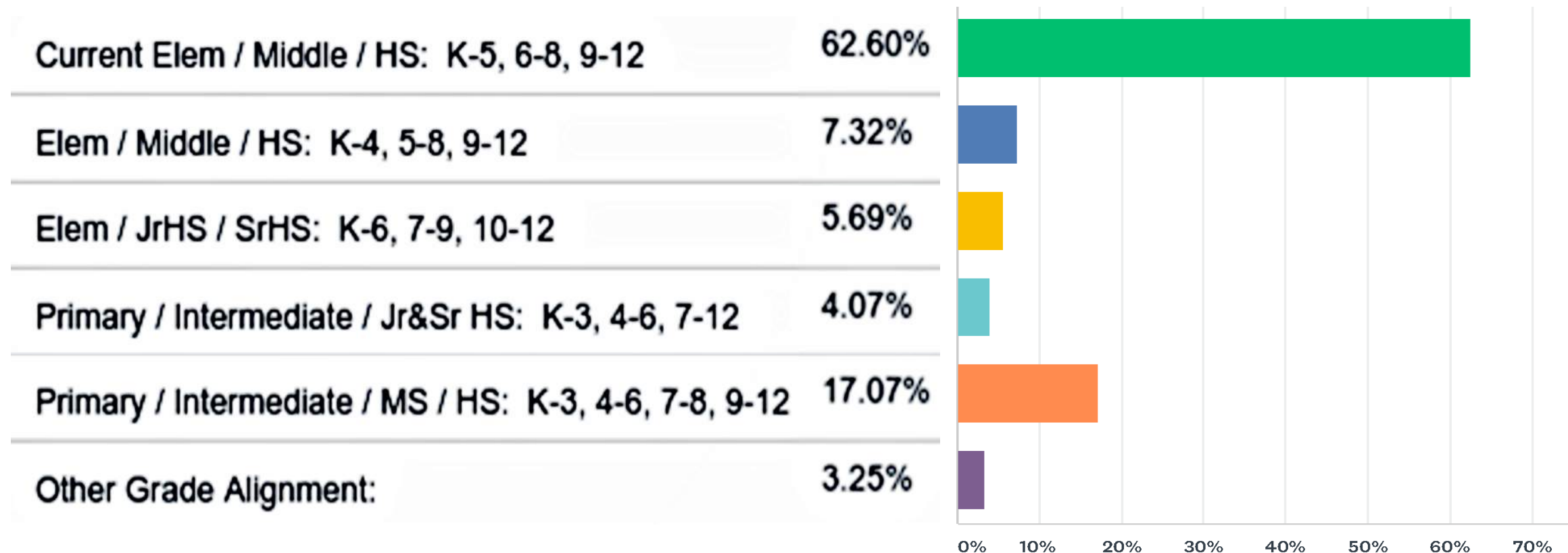

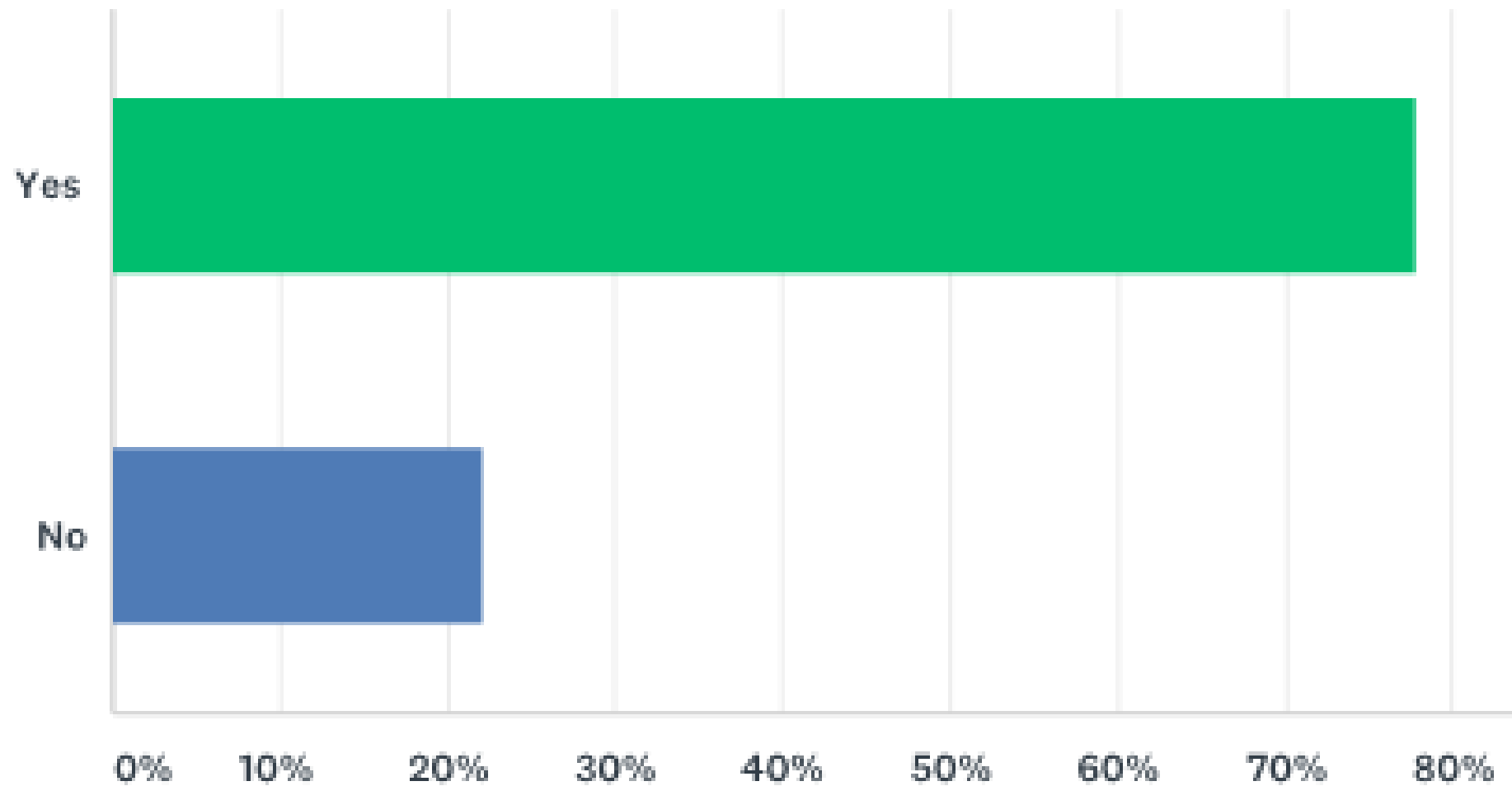
Q13: Is your Classroom/Lab/Office adequate in size for its use?

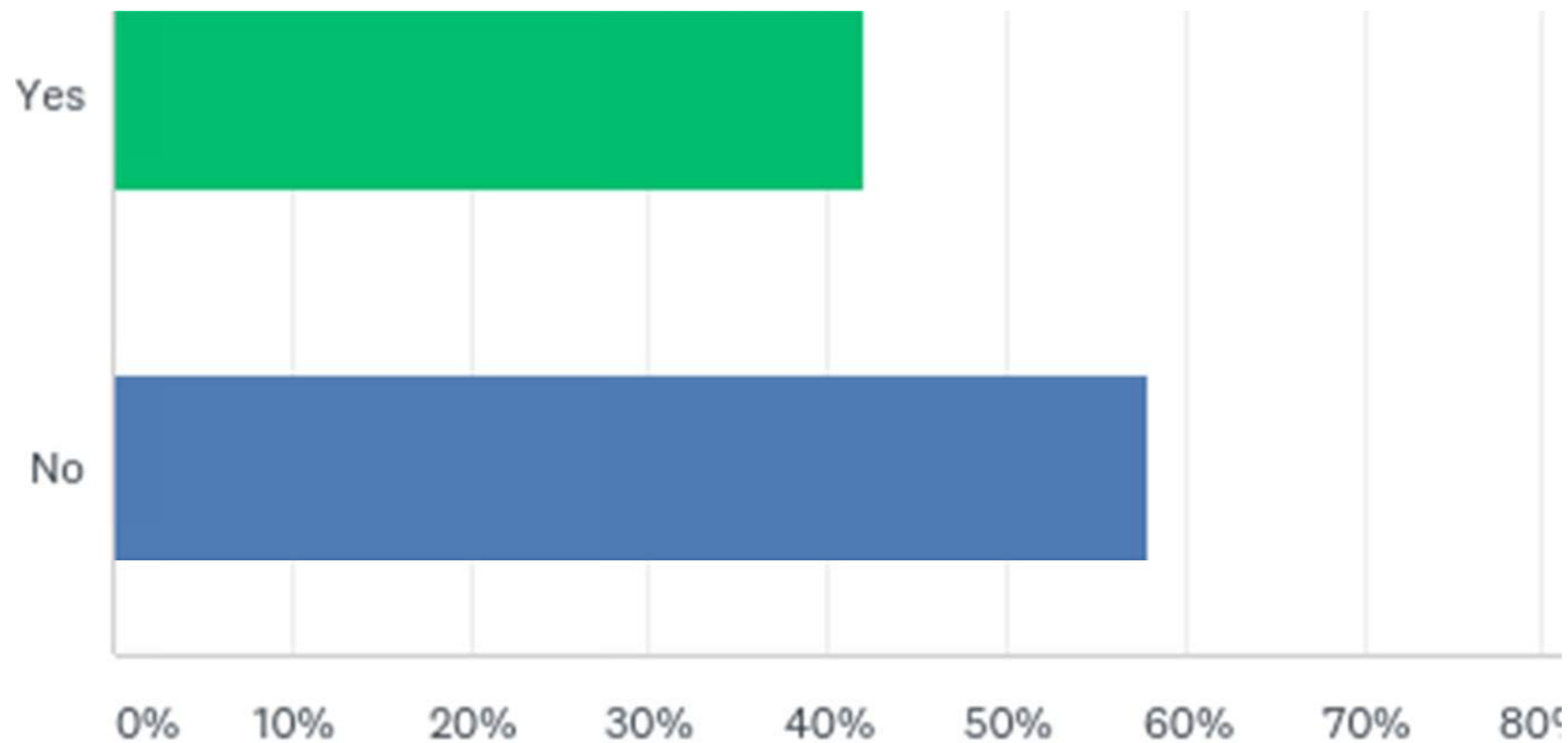
Q17: Are there limitations to instruction from arrangement or equipping of the room?

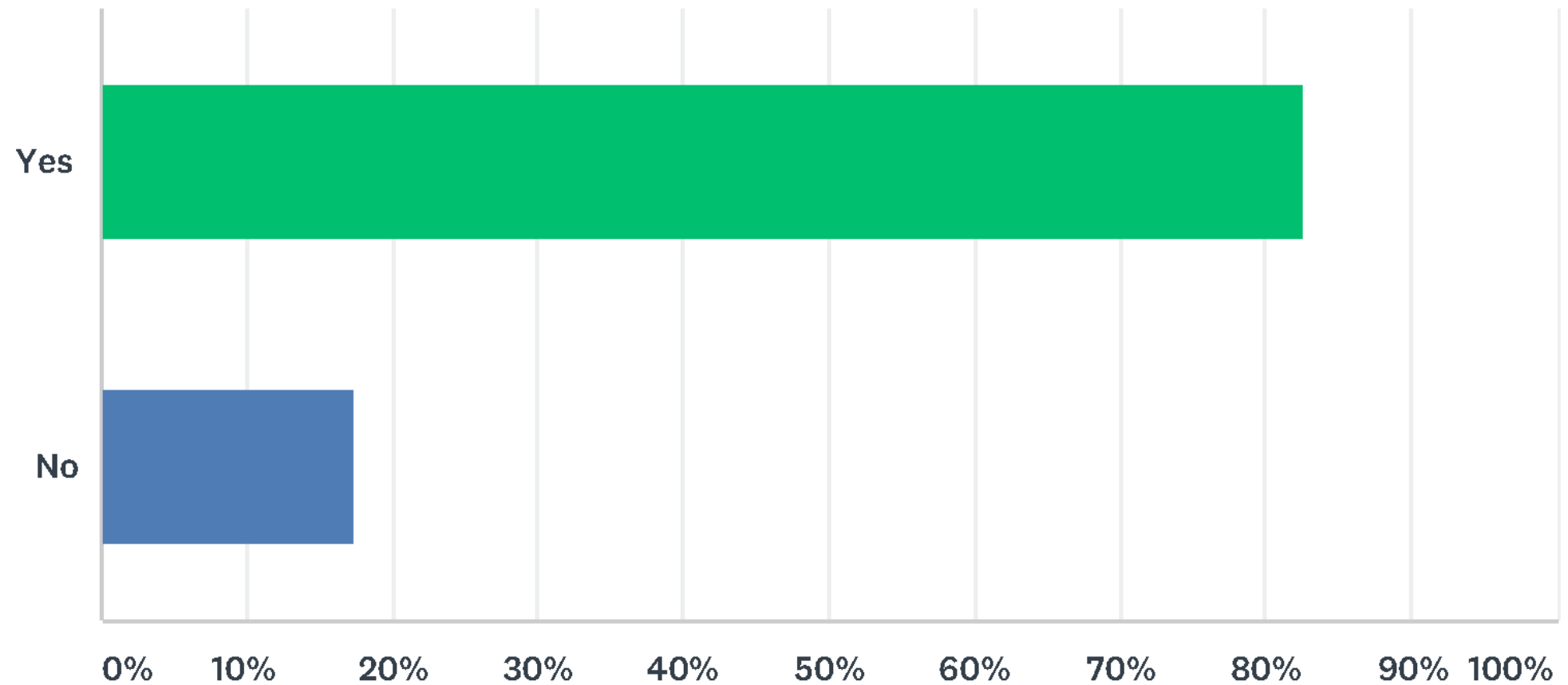
Q45: Does your room have an adequate heating system?

Q45: Does your room have an adequate cooling system?

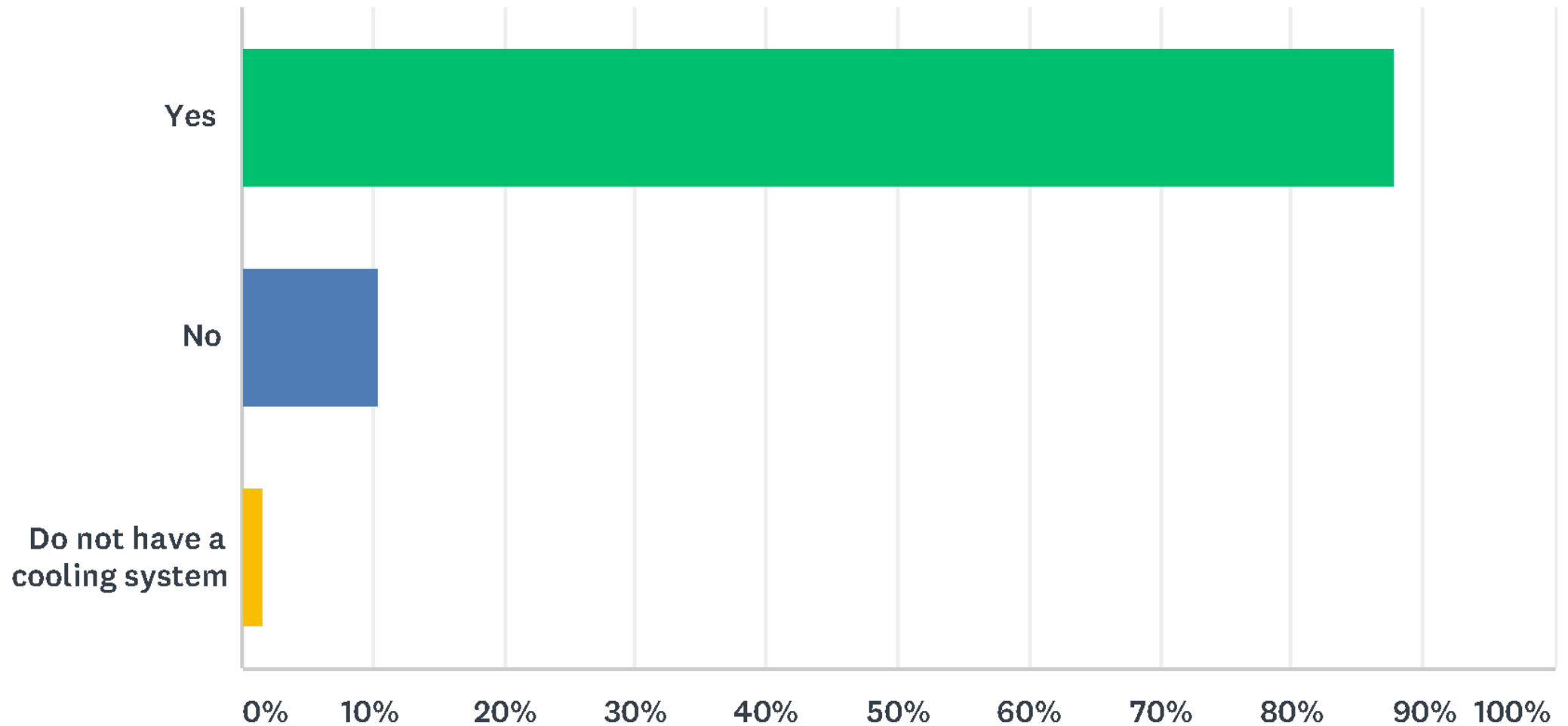

General Trends in Survey Responses

- Majority of staff – 15 years or less
- Individualized learning with use of technology
- Prefer current grade alignment
- Adequate sized classrooms prevail, with most teachers in their own room, which provide adequate computer/internet access
- 40% rooms limited by room arrangement/equipment
- Technology use is preferred in the classroom
- Safe, age appropriate buildings
- Adequate heating, cooling

Budgetary Parameters

Budgetary Parameters

Total Budget

\$ 27,687,601

\$ 14,901 per pupil

- Current fund balance \$ 5,064,568
 - of which \$764,000 is budgeted for 2017/18 shortfall offset
- Staff Costs \$ 17,264,990
62.4%
- Facilities Costs (2600 category) \$ 2,562,066
9.3%
- Debt Service \$ 2,423,700
8.8%
- Consistently among lowest in tax effort of the 6 county School Districts
- Revenue up 13.91% since 2011-12. Expenses up 16.46%

Budgetary Parameters

Debt Service Status

- 2013 GO bond series rolling off 6/30/2018 \$ 1,175,000
- 2014 GO bond series rolling off 2024 \$ 8,481,000
- 2012 GO bond series rolling off 2026 \$ 1,095,000
- 2015 GO bond series rolling off 2036 \$9,815,000
- 2016 GO bond series rolling off 2036 \$9,855,000

Conclusions

Conclusions & Observations

- Special programs have expanded over time
- Population and enrollment declining from 1,863 to an estimated 1,567 over the next 10 years
- District buildings accommodate 2,907 regular and special education students
- All facilities in good to excellent condition
- Debt service is being paid off

Next Steps

Initial thoughts on Options to consider

- Maintain existing buildings and grade alignment ?
- Maintain existing buildings and realign grades to K-2, 3-5, 6-8, 9-12 ?
- Reduce facilities and realign grades
 - Close Southside and change to K-2, 3-6, 7-12 ?
or
 - Close Southside and change to K-3, 4-6, 7-12 ?
or
 - Add Small Addition to Standing Stone to allow K-4, 5-8, 9-12 ?
- Other options?

Option Development & Process

Assemble the Building Advisory Team

Team members sought from school and community

- Members work together for multiple sessions
- Discuss and Evaluate various planning options, develop new options
- Communicate with neighbors and other community members about the team's process and progress – carry community input back to the next team workshops
- Determine priorities for option viability and quality

An interactive and inclusive process.

Priorities for Evaluating Options

- Develop evaluation criteria as a team exercise BEFORE options are developed
- Assign a weight of importance to each item

Option Comparison Matrix: Weighted Priorities

On a scale from 1 to 10, how important are each of the following factors:

| | points | % |
|--|--------|------|
| First cost (based on taxpayer burden) | 7 | 16% |
| Annual commitment (debt offset by indirect savings) | 6 | 13% |
| Ongoing operational costs including maintenance & utilities | 8 | 18% |
| Neighborhood Schools / Walkability | 9 | 20% |
| District flexibility, best use of land and built resources | 2 | 4% |
| Sustainability / Green Design | 3 | 7% |
| Improved Community Access to Facilities | 4 | 9% |
| Historic Building Preservation | 5 | 11% |
| Factors affecting likelihood and speed of execution (referendum, etc.) | 1 | 2% |
| | 43 | 100% |

Developing Options

- Develop options
- Assess quantitative values

| SHRSD ATTRIBUTES CONSIDERED | | OPTIONS | | | | | | | |
|-------------------------------------|--------------|------------------|----------------|-----------------------|------------------|----------------|----------------|--------------------------|---------------|
| FEATURES | Status Quo | Equity Additions | Realign Grades | 2 K-5 ES w/ 6th at HS | 2 K-6 Elementary | K-3, 4-6 @ WA | New 4-6 ES | Expand WA ES for all K-6 | |
| | | | | | | | | | |
| Grade Structure | | | | | | | | | |
| Existing Building Area Remaining | K-6, 7-12 | K-6, 7-12 | K-2, 3-6, 7-12 | K-5, 6-12 | K-6, 7-12 | K-3, 4-6, 7-12 | K-2, 3-6, 7-12 | K-6, 7-12 | |
| New Building Area | 152,079 SF | 152,079 SF | 152,079 SF | 148,221 SF | 148,221 SF | 148,221 SF | 122,439 SF | 114,160 SF | 88,160 SF |
| Total Building Area | 152,079 SF | 8,190 SF | 8,190 SF | 148,221 SF | 15,186 SF | 13,140 SF | 43,000 SF | 38,726 SF | 56,160 SF |
| Total Area Change | --- | 100,269 SF | 160,269 SF | -3,858 SF | 163,407 SF | 161,361 SF | 165,439 SF | 152,886 SF | 144,500 SF |
| BUILDINGS LIVED | | | | | | | | | |
| Avoided Capital Maintenance | --- | 8,190 SF | 8,190 SF | --- | --- | --- | --- | --- | --- |
| Total Number of Buildings | --- | --- | --- | --- | --- | --- | --- | --- | --- |
| FIRST COST | | | | | | | | | |
| Elementary Cost | \$ 6,100,200 | \$ 9,411,650 | \$ 8,814,750 | \$ 8,968,250 | \$ 12,194,650 | \$ 11,959,950 | \$ 16,577,950 | \$ 16,928,850 | \$ 18,317,250 |
| Secondary Cost | \$ 1,673,750 | \$ 1,673,750 | \$ 1,673,750 | \$ 1,673,750 | \$ 1,673,750 | \$ 1,673,750 | \$ 1,673,750 | \$ 1,673,750 | \$ 1,673,750 |
| Total Project Cost | \$ 7,773,950 | \$ 11,085,400 | \$ 10,488,500 | \$ 10,642,000 | \$ 13,868,400 | \$ 13,633,700 | \$ 18,251,700 | \$ 18,602,600 | \$ 19,991,000 |
| FINANCIAL COST | | | | | | | | | |
| State Aid | \$ 0 | \$ 0 | \$ 0 | \$ 0 | \$ 0 | \$ 0 | \$ 0 | \$ 0 | \$ 0 |
| Local Effort | 0.00 % | 0.00 % | 0.00 % | 0.00 % | 0.00 % | 0.00 % | 0.00 % | 0.00 % | 0.00 % |
| Annual Debt Recovery | \$ 7,773,950 | \$ 11,085,400 | \$ 10,488,500 | \$ 10,642,000 | \$ 13,868,400 | \$ 13,633,700 | \$ 18,251,700 | \$ 18,602,600 | \$ 19,991,000 |
| Rate | 7.2% | 7.2% | 7.2% | 7.2% | 7.2% | 7.2% | 7.2% | 7.2% | 7.2% |
| AVERAGE SCORE: | 13.8% | 13.8% | 13.8% | 13.8% | 13.8% | 13.8% | 13.8% | 13.8% | 13.8% |
| ANNUAL COST | | | | | | | | | |
| Avoided Debt on Capital Maintenance | --- | --- | --- | --- | --- | --- | --- | --- | --- |
| Professional Staff Savings | --- | --- | --- | --- | --- | --- | --- | --- | --- |
| Support Staff Savings | --- | --- | --- | --- | --- | --- | --- | --- | --- |
| Food Service Impact | --- | --- | --- | --- | --- | --- | --- | --- | --- |
| Transportation Cost Impact | --- | --- | --- | --- | --- | --- | --- | --- | --- |
| Curricular Cost Impact - TBD | --- | --- | --- | --- | --- | --- | --- | --- | --- |
| Operations/Maint. Existing | \$ 2.15/sf | --- | --- | --- | --- | --- | --- | --- | --- |
| Operations/Maint. New | \$ 1.25/sf | --- | --- | --- | --- | --- | --- | --- | --- |
| Total Indirect Cost Impact | --- | --- | --- | --- | --- | --- | --- | --- | --- |
| Debt Less Indirect Costs/Savings | --- | --- | --- | --- | --- | --- | --- | --- | --- |
| Annual Impact Year 20 | \$ 560,304 | \$ 10,238 | \$ 10,238 | \$ 8,295 | \$ 18,983 | \$ 16,420 | \$ 63,726 | \$ 81,526 | --- |
| AVERAGE SCORE: | 3.0%/yr | 3.0%/yr | 3.0%/yr | 3.0%/yr | 3.0%/yr | 3.0%/yr | 3.0%/yr | 3.0%/yr | 3.0%/yr |
| EXECUTION | | | | | | | | | |
| Speed of Implementation | --- | --- | --- | --- | --- | --- | --- | --- | --- |
| Number of Buildings | --- | --- | --- | --- | --- | --- | --- | --- | --- |
| Community Sentiment | --- | --- | --- | --- | --- | --- | --- | --- | --- |
| Minimal Disruption to District | --- | --- | --- | --- | --- | --- | --- | --- | --- |
| No Borrowing Referendum Required | --- | --- | --- | --- | --- | --- | --- | --- | --- |
| AVERAGE SCORE: | 8.2% | 8.2% | 8.2% | 8.2% | 8.2% | 8.2% | 8.2% | 8.2% | 8.2% |
| WEIGHTED SCORE: | | | | | | | | | |
| | 0.48 | 0.29 | 0.2 | 0.45 | 0.32 | 0.25 | 0.21 | 0.42 | 0.08 |

Developing Options

- Assign qualitative values

| SHRSD ATTRIBUTES CONSIDERED | | OPTIONS | | | | | | | |
|-----------------------------|--|-----------------|-----------------------|---------------------|----------------------------|-----------------------|--------------------|-----------------|----------------------------|
| | | 1 Status Quo | 2 Equity Additions | 3 Realign Grades | 4 2 K-5 ES w/ 6th at HS | 5 2 K-6 Elementary | 6 K-3, 4-6 @ WA | 7 New 4-6 ES | 8 Expand WA for all K-6 |
| PROJECT IMPACT | Preserves Neighborhood Schools | 4 | | | | | | | |
| | Busing Impact | 4 | 4 | | | | | | |
| | Educational Specifications Met | 4 | 4 | 4 | | | | | |
| | Small Class Size | 1 | 2 | 3 | 3 | 3 | 3 | 3 | |
| | Progression Model Supported by 3rd Party Research | 1 | 4 | 2 | 3 | 3 | 3 | 3 | |
| | Improves K-6 Program Offerings | 2 | 2 | 4 | 3 | 4 | 3 | 3 | |
| | Improves 7-12 Program Offerings | 1 | 2 | 2 | 3 | 3 | 4 | 2 | 3 |
| | Improves Pre-K Program Offerings | 0 | 2 | 2 | 2 | 3 | 3 | 4 | 2 |
| | Minimizes School Transitions | 0 | 0 | 2 | 3 | 2 | 3 | 3 | 4 |
| | Athletics: Variety & Participation | 3 | 0 | 0 | 0 | 2 | 2 | 3 | 3 |
| Other Grant Impact | | 4 | 3 | 1 | 2 | 0 | 3 | 2 | 2 |
| AVERAGE SCORE: | | 0 | 4 | 2 | 3 | 2 | 0 | 3 | 4 |
| WEIGHTED SCORE: | | 0.09 | 2.27 | 2.18 | 0.93 | 1.04 | 2.36 | 1.12 | 2.55 |
| STUDENT IMPACT | | | | | | | | | |
| FLEXIBILITY | Scalability with Enrollment Changes | 2 | 2 | 2 | 3 | 3 | 4 | 4 | 4 |
| | Provides Swing Space | 2 | 2 | 2 | 2 | 3 | 3 | 4 | 4 |
| | Potential to Add Future Programs | 2 | 2 | 2 | 3 | 3 | 4 | 4 | 4 |
| | Potential for Resale of Closed Sites | 0 | 2 | 2 | 3 | 3 | 4 | 4 | 4 |
| | Potential for Reuse of Closed Sites | 0 | 0 | 2 | 2 | 3 | 4 | 4 | 4 |
| | Age & Cond of Remaining Bldgs | 0 | 0 | 0 | 2 | 3 | 4 | 4 | 4 |
| | AVERAGE SCORE: | 1 | 0 | 0 | 2 | 3 | 4 | 4 | 4 |
| | WEIGHTED SCORE: | 1.17 | 1.32 | 1.33 | 0.23 | 0.25 | 0.33 | 0.36 | 0.35 |
| | SUSTAINABILITY / GREEN DESIGN | | | | | | | | |
| | Energy Use Reduction | 1 | 1 | 1 | 1 | 2 | 3 | 4 | 4 |
| SUSTAINABILITY / OVER | LEED/Green Globes Potential | 0 | 1 | 1 | 1 | 2 | 3 | 4 | 4 |
| | Student Walkability | 2 | 2 | 2 | 2 | 3 | 4 | 4 | 4 |
| | Transportation Reduction | 0 | 2 | 2 | 2 | 3 | 4 | 4 | 4 |
| | Embodied Energy Savings through Reuse of Existing Building | 4 | 4 | 4 | 3 | 3 | 4 | 4 | 4 |
| | AVERAGE SCORE: | 1.40 | 1.60 | 1.60 | 1.40 | 1.60 | 1.80 | 1.80 | 1.80 |
| | WEIGHTED SCORE: | 0.11 | 0.13 | 0.13 | 0.11 | 0.13 | 0.15 | 0.15 | 0.15 |
| | IMPROVED COMMUNITY ACCESS TO FACILITIES | | | | | | | | |
| | Potential for Shared Community Services | 1 | 1 | 1 | 1 | 2 | 3 | 4 | 4 |
| | Access to Performance Spaces | 2 | 2 | 2 | 2 | 3 | 4 | 4 | 4 |
| | Access to Full Sized Gymnasium | 2 | 2 | 2 | 2 | 3 | 4 | 4 | 4 |
| | Access to Playfields | 1 | 1 | 1 | 1 | 2 | 3 | 4 | 4 |
| AVERAGE SCORE: | | 1.50 | 1.50 | 1.50 | 1.75 | 2.25 | 2.75 | 3.75 | 3.75 |
| WEIGHTED SCORE: | | 0.03 | 0.03 | 0.03 | 0.04 | 0.05 | 0.06 | 0.07 | 0.08 |
| IMPROVED COMMUNITY | Potential for Shared Community Services | 1 | 1 | 1 | 1 | 2 | 3 | 4 | 4 |
| | Access to Performance Spaces | 2 | 2 | 2 | 2 | 3 | 4 | 4 | 4 |
| | Access to Full Sized Gymnasium | 2 | 2 | 2 | 2 | 3 | 4 | 4 | 4 |
| | Access to Playfields | 1 | 1 | 1 | 1 | 2 | 3 | 4 | 4 |
| | AVERAGE SCORE: | 1.50 | 1.50 | 1.50 | 1.75 | 2.25 | 2.75 | 3.75 | 3.75 |
| | WEIGHTED SCORE: | 0.03 | 0.03 | 0.03 | 0.04 | 0.05 | 0.06 | 0.07 | 0.08 |
| | IMPROVED COMMUNITY ACCESS TO FACILITIES | | | | | | | | |
| | Potential for Shared Community Services | 1 | 1 | 1 | 1 | 2 | 3 | 4 | 4 |
| | Access to Performance Spaces | 2 | 2 | 2 | 2 | 3 | 4 | 4 | 4 |
| | Access to Full Sized Gymnasium | 2 | 2 | 2 | 2 | 3 | 4 | 4 | 4 |
| | Access to Playfields | 1 | 1 | 1 | 1 | 2 | 3 | 4 | 4 |
| AVERAGE SCORE: | | 1.50 | 1.50 | 1.50 | 1.75 | 2.25 | 2.75 | 3.75 | 3.75 |
| WEIGHTED SCORE: | | 0.03 | 0.03 | 0.03 | 0.04 | 0.05 | 0.06 | 0.07 | 0.08 |

Developing Options

- Assign qualitative values
- Compute objective ranking of options based on weighted, prioritized quality criteria
- Discuss ALL options

| SHRSD ATTRIBUTES CONSIDERED | | OPTIONS | | | | | | | | | |
|--------------------------------|---------------------------------|------------|------------------|----------------|-----------------------|------------------|---------------|------------|--------------------------|-----------|----------------|
| | | 1 | 2 | 3 | 4 | 5 | 6 | 7 | 8 | 9 | 10 |
| HISTORIC BUILDING PRESERVATION | | Status Quo | Equity Additions | Realign Grades | 2 K-5 ES w/ 6th at HS | 2 K-5 Elementary | K-3, 4-5 @ WA | New 4-5 ES | Expand WA ES for all K-5 | K-12 @ HA | One New K-5 ES |
| HISTORIC | Significant Buildings Preserved | 4 | 4 | 4 | 0 | 0 | 0 | 0 | 0 | 0 | 0 |
| | AVERAGE SCORE: | 4.00 | 4.00 | 4.00 | 0.00 | 0.00 | 0.00 | 0.00 | 0.00 | 0.00 | 0.00 |
| WEIGHTED SCORE: | | 0.12 | 0.12 | 0.12 | 0 | 0 | 0 | 0 | 0 | 0 | 0 |
| SUMMARY | WEIGHTED AVERAGE | 2.48 | 2.29 | 2.18 | 2.45 | 2.28 | 2.21 | 1.92 | 2.26 | 2.40 | 1.85 |
| | RANKING | 1 | 4 | 8 | 2 | 5 | 7 | 9 | 6 | 3 | 10 |
| VOTING RESULTS | | 7 | 9 | 3 | 12 | 7 | 2 | 3 | 4 | 8 | 4 |

Schedule

| | |
|--|--|
| August 15 - | Notice to Proceed |
| August 30 - | Initial Q&A with Division Staff |
| August 31 - September 18 - | Development & Presentation of a Timeline |
| September 13 - | Building Walkthroughs |
| September 18 - | Introduction & Presentation to the School Board |
| <hr/> | |
| Phase 1, Data Collection | |
| September 18 - | Development of School Board & Stakeholder Committee |
| September 19 - October 13 - | Staff Survey Distribution |
| November 13 | Review with Board Sub-Committee (5:30) |
| November 20 | Board/Public Presentation (6:30) |
| <hr/> | |
| Phase 2, Option Development | |
| November 20 | Stakeholder Input Session: Kickoff (Establishing Goals and reviewing "Common Knowledge") (5:30) |
| December 6 | Stakeholder Input Session: Review of Findings & Initial Options (5:30) |
| December 20 | Stakeholder Input Session: Option Review (5:30) |
| January 4 | Stakeholder Input Session: Option Review (5:30) |
| January 8 | Review with Board Sub-Committee (5:30) |
| January 15 | Board/Public Presentation (6:30) |

Schedule

| | |
|-----------------------|--|
| January 16 - March 12 | Phase 3, Option Refinement |
| February 21 | Maps & Statistical Refinement |
| March 12 | Stakeholder Input Session: Option Review (5:30) (optional) |
| March 19 | Review with Board Sub-Committee (5:30) |
| | Final Board Presentation (6:30) |
| April 9 | Phase 3, Final Master Action Plan Report |
| | Board Review & Closeout |